

Public Document Pack

DOVER JOINT TRANSPORTATION ADVISORY BOARD

White Cliffs Business Park Dover Kent CT16 3PJ
Telephone: (01304) 821199 Facsimile: (01304) 872452

9 March 2021

Dear Councillor

NOTICE IS HEREBY GIVEN THAT a meeting of the **DOVER JOINT TRANSPORTATION ADVISORY BOARD** will be held as a Teams – Live Event on Thursday 18 March 2021 at 6.00 pm when the following business will be transacted.

Members of the public who require further information are asked to contact Kate Batty-Smith, Democratic Services Officer on (01304) 872303 or by e-mail at democraticservices@dover.gov.uk.

Yours sincerely

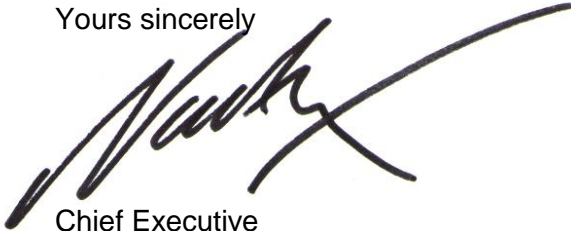

Chief Executive

Dover Joint Transportation Advisory Board Membership:

Dover District Council Members

J S Back (Chairman)
M Bates
E A Biggs
D G Cronk
J P Haste
M J Holloway
N S Kenton

Kent County Council Members

S C Manion (Vice-Chairman)
P M Beresford
T A Bond
S S Chandler
N J Collor
G Lymer
D P Murphy

Town Councils and Kent Association of Local Councils (non-voting)

Mr B W Bano (Deal Town Council)
Mrs P M Brivio (Dover Town Council)
Mr P Carter (Sandwich Town Council)
Mr K Gowland (Kent Association of Local Councils)
Mr A P Minns (Kent Association of Local Councils)



AGENDA

1 **APOLOGIES**

To receive any apologies for absence.

2 **APPOINTMENT OF SUBSTITUTE MEMBERS**

To note appointments of Substitute Members.

3 **DECLARATIONS OF INTEREST** (Page 4)

To receive any declarations of interest from Members in respect of business to be transacted on the agenda.

4 **MINUTES** (Pages 5-7)

To confirm the attached minutes of the meeting of the Board held on 3 December 2020.

PART A

5 **REGENERATION OF MARKET SQUARE, DOVER - TRAFFIC REGULATION ORDER**

To consider the report of the Director of Highways and Transportation, Kent County Council (to follow).

6 **HIGHWAY WORKS PROGRAMME 2019/20 ONWARDS** (Pages 8-23)

To consider the attached report of the Director of Highways and Transportation, Kent County Council.

PART B

7 **PROPOSED RESIDENTS' PARKING SCHEME - HEWITT ROAD AND GOODFELLOW WAY, DOVER** (Pages 24-32)

To consider the attached report of the Strategic Director (Operations and Commercial).

8 **PROPOSED RESIDENTS' PARKING SCHEME - HAROLD STREET AREA, DOVER** (Pages 33-37)

To consider the attached report of the Strategic Director (Operations and Commercial).

9 **PROPOSED ELECTRIC VEHICLE CHARGING POINT PROVISION** (Pages 38-48)

To consider the attached report of the Strategic Director (Operations and Commercial).

- 10 **PROPOSED PARKING CHARGE INCREASE IMPLEMENTATION 2021/22** (Pages 49-52)

To consider the attached report of the Strategic Director (Operations and Commercial).

- 11 **DOVER SEAFRONT - PROPOSED CARAVAN AND MOTOR CARAVAN PARKING RESTRICTIONS** (Pages 53-60)

To consider the attached report of the Strategic Director (Operations and Commercial).

- 12 **EXCLUSION OF THE PRESS AND PUBLIC** (Pages 61-63)

The recommendation is attached.

The procedure for determining applications for on-street disabled persons' parking bays is attached.

MATTERS WHICH THE MANAGEMENT TEAM SUGGESTS SHOULD BE CONSIDERED IN PRIVATE AS THE REPORT CONTAINS EXEMPT INFORMATION AS DEFINED WITHIN PART 1 OF SCHEDULE 12A OF THE LOCAL GOVERNMENT ACT 1972 AS INDICATED AND IN RESPECT OF WHICH THE PROPER OFFICER CONSIDERS THAT THE PUBLIC INTEREST IN MAINTAINING THE EXEMPTION OUTWEIGHS THE PUBLIC INTEREST IN DISCLOSING THE INFORMATION

- 13 **APPLICATIONS FOR DISABLED PERSONS' PARKING BAYS** (Pages 64-79)

To consider the attached report of the Strategic Director (Operations and Commercial).

Access to Meetings and Information

- Members of the public are welcome to attend meetings of the Council, its Committees and Sub-Committees. You may remain present throughout them except during the consideration of exempt or confidential information.
- All meetings are held at the Council Offices, Whitfield unless otherwise indicated on the front page of the agenda. There is disabled access via the Council Chamber entrance and a disabled toilet is available in the foyer. In addition, there is a PA system and hearing loop within the Council Chamber.
- Agenda papers are published five clear working days before the meeting. Alternatively, a limited supply of agendas will be available at the meeting, free of charge, and all agendas, reports and minutes can be viewed and downloaded from our website www.dover.gov.uk. Minutes will be published on our website as soon as practicably possible after each meeting. All agenda papers and minutes are available for public inspection for a period of six years from the date of the meeting.
- If you require any further information about the contents of this agenda or your right to gain access to information held by the Council please contact Kate Batty-Smith, Democratic Services Officer, democraticservices@dover.gov.uk, telephone: (01304)

872303 or email: democraticservices@dover.gov.uk for details.

Large print copies of this agenda can be supplied on request.

Declarations of Interest

Disclosable Pecuniary Interest (DPI)

Where a Member has a new or registered DPI in a matter under consideration they must disclose that they have an interest and, unless the Monitoring Officer has agreed in advance that the DPI is a 'Sensitive Interest', explain the nature of that interest at the meeting. The Member must withdraw from the meeting at the commencement of the consideration of any matter in which they have declared a DPI and must not participate in any discussion of, or vote taken on, the matter unless they have been granted a dispensation permitting them to do so. If during the consideration of any item a Member becomes aware that they have a DPI in the matter they should declare the interest immediately and, subject to any dispensations, withdraw from the meeting.

Other Significant Interest (OSI)

Where a Member is declaring an OSI they must also disclose the interest and explain the nature of the interest at the meeting. The Member must withdraw from the meeting at the commencement of the consideration of any matter in which they have declared a OSI and must not participate in any discussion of, or vote taken on, the matter unless they have been granted a dispensation to do so or the meeting is one at which members of the public are permitted to speak for the purpose of making representations, answering questions or giving evidence relating to the matter. In the latter case, the Member may only participate on the same basis as a member of the public and cannot participate in any discussion of, or vote taken on, the matter and must withdraw from the meeting in accordance with the Council's procedure rules.

Voluntary Announcement of Other Interests (VAOI)

Where a Member does not have either a DPI or OSI but is of the opinion that for transparency reasons alone s/he should make an announcement in respect of a matter under consideration, they can make a VAOI. A Member declaring a VAOI may still remain at the meeting and vote on the matter under consideration.

Note to the Code:

Situations in which a Member may wish to make a VAOI include membership of outside bodies that have made representations on agenda items; where a Member knows a person involved, but does not have a close association with that person; or where an item would affect the well-being of a Member, relative, close associate, employer, etc. but not his/her financial position. It should be emphasised that an effect on the financial position of a Member, relative, close associate, employer, etc OR an application made by a Member, relative, close associate, employer, etc would both probably constitute either an OSI or in some cases a DPI.

Minutes of the meeting of the **DOVER JOINT TRANSPORTATION ADVISORY BOARD** held remotely on Thursday, 3 December 2020 at 6.01 pm.

Present:

Chairman: Councillor S C Manion

Councillors: M Bates
P M Beresford
E A Biggs
T A Bond
S S Chandler
N J Collor
D G Cronk
J P Haste
M J Holloway
P D Jull
N S Kenton
G Lymer (Minute Nos 60-63 only)
D P Murphy (Minute Nos 60-63 only)

Also present: Mrs P M Brivio (Dover Town Council)
Mr P Carter (Sandwich Town Council)
Mr A P Minns (Kent Association of Local Councils)

Officers: Dover District Manager (Kent County Council Highways)
Thanet District Manager (Kent County Council Highways)
Transport and Parking Services Manager
Parking Operations Officer
Democratic Services Manager
Democratic Services Officer

57 APOLOGIES

It was noted that apologies for absence had been received from District Councillor J S Back and Messrs B W Bano (Deal Town Council), K Gowland (Kent Association of Local Councils) and L Kettlewell (Deal Town Council nominated substitute).

58 APPOINTMENT OF SUBSTITUTE MEMBERS

It was noted that, in accordance with Council Procedure Rule 4, Councillor P D Jull had been appointed as a substitute member for Councillor J S Back.

59 DECLARATIONS OF INTEREST

There were no declarations of interest.

60 MINUTES

The minutes of the meeting held on 10 September 2020 were approved as a correct record and signed by the Chairman.

61 HIGHWAY WORKS PROGRAMME 2019/20 ONWARDS

The Dover District Manager presented the report which provided an update on schemes that had been programmed for delivery in 2020/21.

Members were advised that there were two remedial schemes at Bellers Bush and Deal Road roundabouts at Sandwich that were programmed to be completed overnight on 15 and 16 December. She clarified that budget certainty would be known by February, and a works programme was likely to have been developed by the time of the June Board meeting. In response to Councillor S S Chandler, the DDM undertook to look into a street-light column in Bowling Street, Sandwich which had seemingly been replaced with a non-heritage one. At Councillor N J Collor's request, she also undertook to check that works to replace columns at East Cliff, Dover had been completed. In respect of rural areas, she advised Councillor M Bates that some columns were the responsibility of Dover District Council rather than Kent County Council (KCC). Responsibilities could be clarified by using the map on KCC's website.

RESOLVED: That the report be noted.

62 EXCLUSION OF THE PRESS AND PUBLIC

It was moved by Councillor Pauline Beresford, duly seconded and

RESOLVED: That, under Section 100(A)(4) of the Local Government Act 1972, the public be excluded from the meeting for the remainder of the business on the grounds that the item to be considered involved the likely disclosure of exempt information as defined in paragraphs 1 and 2 of Part I of Schedule 12A of the Act.

63 APPLICATIONS FOR DISABLED PERSONS' PARKING BAYS

The Parking Operations Officer (POP) presented the report which outlined details of fourteen disabled parking bay applications, and proposed the removal of six bays that were no longer needed.

In respect of Applications A, J and M, the POP confirmed that the roads were wide enough and there would be no problems with junction access. He was aware of concerns raised about Application E. He clarified that the bay would be located on the opposite side of the road to the proposed passing places. Moreover, the application met all the criteria and related to a severely disabled child. Application N was only before the Board because, if approved, the total number of bays in the road would exceed 5% of the overall parking available.

RESOLVED: (a) That it be noted:

- (i) That Applications A to M would be formally advertised and, in the event that no objections are received, sealed by Kent County Council. (Should any objections be received during the consultation process, the applications will be discussed with the Chairman of the Dover Joint Transportation Advisory Board for a final decision.)
- (ii) That Items N to T would be formally advertised with the intention of removing them and, in the event that

no objections are received, their removal will be sealed by Kent County Council.

- (b) That it be recommended that Application N be approved and formally advertised and, in the event that no objections are received, sealed by Kent County Council. (Should any objections be received during the consultation process, the applications will be discussed with the Chairman of the Dover Joint Transportation Advisory Board for a final decision.)

The meeting ended at 6.44 pm.

To: Dover Joint Transportation Advisory Board
By: KCC Highways, Transportation & Waste
Date: 18 March 2021
Subject: Highway Forward Works Programme – 2019/20 onwards
Classification: Information Only

Summary: This report updates Members on the identified schemes approved for construction

1. Introduction

This report provides an update and summarises schemes that have been programmed for delivery in 2020/21.

Kent County Council has agreed a substantial increase in the budget for planned highway works over the next three years, and as a result we are still in the process of identifying and designing schemes for inclusion in our full Year One to Two (2019/20 and 2020/21) and Year Three to Five (2021/22 to 2023/24) programmes. Because of this, we have decided to publish an interim programme, and to publish the full programmes later this year. For some assets this interim programme covers approximately the first six months of 2019/20, whilst for others it includes most of the works planned for the whole year.

This programme is subject to regular review and may change for a number of reasons including budget allocation, contract rate changes, and to reflect KCC's changing priorities. The programme and extent of individual sites within the programme may also be revised following engineering assessment during the design phase.

Road, Footway & Cycleway Renewal and Preservation Schemes – see Appendix A

Drainage Repairs & Improvements – see Appendix B

Street Lighting – see Appendix C

Transportation and Safety Schemes – see Appendix D

- **Casualty Reduction Measures**
- **Externally funded schemes**

Developer Funded Works – see Appendix E

PROW – see Appendix F

Bridge Works – see appendix G

Traffic Systems – see Appendix H

Combined Member Fund – see Appendix I

Street Works – see Appendix J

Conclusion

1. This report is for Members' information.

Contact Officers:

The following contact officers can be contacted on **03000 418181**

Toby Howe	Highway Manager East Kent
Stephanie Wadhams	Dover District Manager
Alan Casson	Strategic Asset Manager
Earl Bournier	Drainage & Structures Asset Manager
Sue Kinsella	Street Light Asset Manager
Toby Butler	Traffic & Network Solutions Asset Manager
Jamie Hare	Development Agreements Manager
Nikola Floodgate	Schemes Programme Manager

Appendix A – Road, Footway and Cycleway Renewal and Preservation Scheme

The delivery of these schemes is weather dependent; should it prove not possible to carry out these works on the planned dates, new dates will be arranged, and the residents will be informed by a letter drop to their homes.

Road Asset Renewal Schemes – Contact Officer: Byron Lovell			
Road Name	Parish	Extent of Works	Current Status
A258 Sandwich Road	Worth	Bettshanger Roundabout through to Jubilee Road	Completed
A257 Canterbury Rd	Wingham	Retexturing: Outside Waterlock Cottages	To be programmed summer 2021
Lower Street	Eastry	Eastry High St to Sandwich Road	To be programmed summer 2021
Footway/Cycleway Asset Renewal & Preservation Schemes - Contact Officer: Neil Tree			
Road Name	Parish	Extent of Works	Current Status
Biggin Street (Phase 2)	Dover	Footway resurfacing – North side between Pencester Road to Cannon Street (St Mary's Church)	Completed
Dover Road	Sandwich	Footway stabilisation works. East footway between the level crossing and St. Bart's Road	Testing and detailed outline design completed. Technical approvals and other agency permissions being sought. These are required before a programme date can be agreed.
Deanwood Road	River	(Footway Reconstruction) Various sections throughout entire length to be identified.	Completed.
A257 Canterbury Road	Wingham	Bank stabilisation and	Topographical

		highway remedial works at Wingham Bridge.	survey, culvert inspection and Geotechnical and ecological reports received. Outline design undertaken prior to technical approval application.
--	--	-------------------------------------------	-------------------------------------------------------------------------------------------------------------------------------------------------

Surface Treatments - Contact Officer Jonathan Dean

Road Name	Parish	Extent of Works	Current Status
FOLKESTONE ROAD	Dover	From Station Bridge to roundabout Elms Vale Road	Completed
C231 LWR MILL LN J/W C321 WILLOW WDS RD	NORTHBOURNE	Willow woods road to Northbourne Lane	Completed
ROMAN ROAD	Staple/Ash	From Wingham Country Mareket to Pedding Hill	Completed
PIKE ROAD	TILMANSTONE	Thornton Road to Industrial Estate	Completed
NEW DOVER ROAD	Capel-le-Ferne	From A20 to Winehouse Road	Completed
BARFRESTONE ROAD	Shepherdswell with Coldred	From Eythorne Road to Long Lane	Completed
C201 RUBERRIES WOOD ROAD FROM DISTRICT B	Nonington	From Frogham to Railway	Completed
STRAIGHT MILE	BETTESHANGER	From the prep school to Northbourne Road	Completed
FOLKESTONE ROAD	Dover	Shakespeare Road to 413 Folkestone Rd	Completed
CANTERBURY ROAD, LYDDEN	LYDDEN	Between Church Lane (by pond) to rail bridge over road)	Completed
SANDWICH ROAD	WHITFIELD	Between A256 Bypass to 40mph speed change as entering Whitfield	Completed

Appendix B - Drainage

Drainage Works – Contact Officer: Earl Bournier			
Road Name	Parish	Description of Works	Current Status
The Street	East Langdon	Replacement of failed soakaway on village green	Working progressing on site

Mill Road	Wingham	Ground Investigations for possible deep bored soakaway.	Ground investigation complete. Awaiting responses from landowners at present
Elmstone	Ash	Possible further works required due to collapsed pipe in field	Ongoing works - Investigation continues
Preston Lane	Preston	Cleansing of existing gullies and drainage.	Works undertaken; further works required.
Santon Lane	Stourmouth	Investigate culvert	Works Completed. Culvert cleared and now flowing.

Appendix C – Street Lighting

Structural testing of KCC owned streetlights has identified the following as requiring replacement. A status of complete identifies that the column replacement has been carried out. Programme dates are identified for those still requiring replacement.

Street Lighting Column Replacement – Contact Officer: Sue Kinsella			
Road Name	Parish	Description of Works	Current Status
Worthington Road	Dover	Replacement of 1 streetlight complete with LED Lantern	Works to be completed by April 2021
York Street	Dover	Replacement of 1 Sign light complete with LED Lantern	Await confirmation of Road Closure
The Strand	Deal	Replacement of 1 streetlight complete with LED Lantern	Works Completed
High Street	Deal	Replacement of 2 streetlights complete with LED Lantern	Await confirmation of Road Closure
The Chain	Sandwich	Replacement of 1 sign light complete with LED Lantern	Await confirmation of Road Closure
London Road	Dover	Replacement of 3 streetlights complete with LED Lantern	Works to be completed by April 2021
Ash Road	Sandwich	Replacement of 2 streetlights complete with LED Lantern	Await confirmation of Road Closure
London Road	Deal	Replacement of 3 streetlights complete with LED Lantern	Works Completed

Sandwich Bypass	Sandwich	Replacement of 1 streetlight complete with LED Lantern	Await confirmation of Road Closure
Beach Street	Deal	Replacement of 1 streetlight complete with LED Lantern	Await confirmation of Road Closure
Mongeham Road	Deal	Replacement of 1 streetlight complete with LED Lantern	Works to be completed by April 2021
Old Folkestone Road	Dover	Replacement of 1 streetlight complete with LED Lantern	Works to be completed by April 2021
Farthingloe Road	Dover	Replacement of 1 streetlight complete with LED Lantern	Works to be completed by April 2021
Crabble Hill	Dover	Replacement of 1 streetlight complete with LED Lantern	Works to be completed by April 2021
London Road	Dover	Replacement of 5 streetlights complete with LED Lantern	Await confirmation of Road Closure
Buckland Avenue	Dover	Replacement of 1 streetlight complete with LED Lantern	Works to be completed by April 2021
Channel View Road	Dover	Replacement of 1 streetlight complete with LED Lantern	Works to be completed by April 2021
Farthingloe Road	Dover	Replacement of 1 streetlight complete with LED Lantern	Works to be completed by April 2021
London Road	Deal	Replacement of 2 streetlights complete with LED Lantern	Works Completed
Crabble Hill	Dover	Replacement of 1 streetlight complete with LED Lantern	Await confirmation of Road Closure
London Road	Dover	Replacement of 5 streetlights complete with LED Lantern	Await confirmation of Road Closure
Buckland Avenue	Dover	Replacement of 1 streetlight complete with LED Lantern	Works to be completed by April 2021
Channel View Road	Dover	Replacement of 1 streetlight complete with LED Lantern	Works to be completed by April 2021
Mongeham Road	Deal	Replacement of 2 streetlights complete with LED Lantern	Works to be completed by April 2021

Strand Street	Sandwich	Replacement of 1 streetlight complete with LED Lantern	Works to be completed by April 2021
Cavell Square	Deal	Replacement of 1 streetlight complete with LED Lantern	Works to be completed by April 2021
The Beach	Deal	Replacement of 1 streetlight complete with LED Lantern	Works to be completed by April 2021
London Road	Deal	Replacement of 2 streetlights complete with LED Lantern	Works to be completed by April 2021
A256 Eastry Bypass	Eastry	Replacement of 2 streetlights complete with LED Lantern	Await confirmation of Road Closure
Harris Alley	Wingham	Replacement of 1 streetlight complete with LED Lantern	Works to be completed by April 2021
Melbourne Avenue	Dover	Replacement of 1 sign lights complete with LED Lantern	Works to be completed by April 2021
St Radigunds Road	Dover	Replacement of 1 streetlight complete with LED Lantern	Works to be completed by May 2021
Robert Street	Deal	Replacement of 1 streetlight complete with LED Lantern	Works to be completed by April 2021
Paradise Row	Sandwich	Replacement of 1 streetlight complete with LED Lantern	Works to be completed by May 2021
Dover Road	Deal	Replacement of 1 sign lights complete with LED Lantern	Await confirmation of Road Closure
Sandwich Bypass	Sandwich	Replacement of 3 streetlights complete with LED Lantern	Await confirmation of Road Closure
Park Avenue	Deal	Replacement of 1 streetlight complete with LED Lantern	Works Completed

South Military Road	Dover	Replacement of 1 streetlight complete with LED Lantern	Works to be completed by April 2021
Honeywood Parkway	Dover	Replacement of 1 streetlight complete with LED Lantern	Works to be completed by May 2021
Dover Road	Sandwich	Replacement of 2 sign lights complete with LED Lantern	Works to be completed by May 2021
Deal Road	Sandwich	Replacement of 2 sign lights complete with LED Lantern	Works to be completed by May 2021
Hirst Close	Dover	Replacement of 1 streetlight complete with LED Lantern	Works to be completed by April 2021
Church Lane	Deal	Replacement of 1 streetlight complete with LED Lantern	Works to be completed by April 2021
Sandwich Bypass	Sandwich	Replacement of 4 Bollards complete with LED Lantern	Await confirmation of Road Closure

Appendix D – Transportation and Safety Schemes

Casualty Reduction Measures

The Schemes Planning & Delivery team is implementing schemes within the Dover District in order to meet Kent County Council's (KCC) strategic targets (for example, addressing traffic congestion or improving road safety). Casualty reduction measures have been identified to address a known history of personal injury crashes. Current status correct as of 8/6/2020.

Casualty reduction measures (reactive) – Dover: Louise Winch			
Road Name	Parish	Description of Works	Current Status
2021/22: C231 Willow Road junction with C232 Deal Road, Little Mongeham	Sutton	Installation of STOP function on Beacon Whill, Yellow backed signage in vicinity and improvements to direction signage	DETAILED DESIGN STAGE
2021/22: A256 London Road junction with Tower Hamlets Road	Dover	Improvements to carriageway markings and signage. Installation of 'No Loading' ban (double blips) at bottle next/junction	DETAILED DESIGN COMPLETE – IN ROAD SAFETY AUDIT STAGE 1&2
A266 Sandiwch bypass roundabout junction with A258 Deal Road, Beller's Bush Sandwich	Sandwich	'No Right Turn' ban on laybys either side of the A266. Improvements to signage on the approach to the roundabout	OUTLINE DESIGN STAGE
Local Transport Plan Schemes - Contact Officer: Louise Winch			
Road Name	Parish	Description of Works	Current Status
London Road	River	Installation of zebra crossing point	DETAILED DESIGN
Integrated Transport Schemes – Contact Officer: Louise Winch			
Road Name	Parish	Description of Works	Current Status
Local Growth Fund Schemes - Contact Officer: Louise Winch			
No planned works.			
Section 106 Schemes – Contact Officer: Louise Winch			

Road Name	Parish	Description of Works	Current Status

Appendix E – Developer Funded Works

Developer Funded Works (Section 278 Agreement Works)			
Scheme location/Project number	Parish	Description	Current status
Dover Road, Sandwich DO003439	Sandwich	New bell-mouth access into private development and new footways.	278 Agreement in place.
South Wall Road, Deal DO003440	Deal	Footway improvements.	278 application received. Drawing acceptance given.
Former Custodians Cottage. Victoria Road DO003437	Deal	New crossing point with footway improvements.	278 application received. Drawing acceptance given.
Durlock Road, Staple DO003436	Staple	New bell-mouth access into private development and new footways.	278 application received.
Market Place (Road 1.4) Aylesham Village expansion works. DO003034	Aylesham	Amendments to Market Square including ben widening and additional parking areas.	Works completed apart from a number of minor street lighting issues.
Dorman Avenue North (Road 1.3) Aylesham Village expansion works. DO003040	Aylesham	New footways, laybys and resurfacing of carriageway.	Works complete, waiting for completion of legal agreements and commuted sums.
367 Folkestone Road, Dover. DO003448	Dover	New vehicle crossings and footway.	278 application received.
KFC A256 Ramsgate Road, Sandwich. DO003449	Sandwich	New bellmouth entrance.	278 application received
New Church Honeywood Parkway DO003309	Dover	Developer to construct a new entrance.	278 agreement is in place. Works complete.
DO003407 Archers Court Road.	Archers Court Road, Whitfield	New school crossing point.	Highway work to install a new pedestrain crossing point. Works complete.
Nursing Home Wellington Road, Temple Ewell DO003445	Temple Ewell	Semara Farm Woodnesbough Rd, Eastry	278 application received.
Former Greyhound pub. DO003404,	Dorman Avenue	New entrance and footway	New entrance and footway. Highway

	South, Aylesham CT3 3AA.		works are complete.
Old Park Hill DO003011	Dover	Footway works connected with S38 development.	Awaiting resurfacing.
Monks Way, Sandwich DO003443	Sandwich	New bellmouth entrance.	278 agreement in place, works due to start in April 2021.
Semara Farm Woodnesbough Rd, Eastry DO003442	Sandwich	Carriageway improvements.	278 application received.
Singledge Lane, Whitfield DO003084	Dover	Pedestrian/footway & Carriageway improvements.	Works underway. Carriageway resurfacing to be undertaken in August 2021.
Cambridge Road (read of Cullin's Yard). DO003025	Dover	Removal of traffic calming buildout associated with the redevelopment of Dover Esplanade via Dover Harbour Revision Order SI no. 416	Letter of Agreement in place, Works to be completed by Summer 2021.
The Street Preston DO003044	Preston	Pedestrian/footway improvements.	278 highway works are completed. Final certificate has been issued.
Grove Road/ Stourmouth Road. DO003056	Preston	New bell-mouth access into private development and new footways.	Works underway.
Church Lane, Deal. DO003095	Deal	Pedestrian/footway improvements.	Footway works are completed. 1 st certificate issued.
Station Road DO003039	Walmer	Relocation of bus stops on Dover road and adjustments to kerb lines.	S278 approval given. Works are due to start in April 2021.
Dublin development, Former PH, Lower Road, River DO003250	Dover	New footway and vehicle crossings.	Highway works completed. 2 st certificate issued.
Halsbury Homes Ltd new development DO003015	Whitfield	New Roundabout	Works completed. 2 nd Certificate issued.
Hammill Brickworks Selson Lane/Hammill Road. DO003081	Woodnesbo rough	New bell-mouth access into private development and minor alterations to existing access.	Phase 2, highway works completed.
Manor View, Lower Road Temple Ewell DO003441	Temple Ewell	New bell-mouth access into private development and minor alterations to existing access.	278 application received. Drawing acceptance given.

Leisure centre, Honeywood park Ind est. DO003111	Dover	Construction of a new leisure centre with access roads.	S278 Agreement issued. Phase 2 Works to be completed by the end of 2021.
-----------------------------------------------------	-------	---------------------------------------------------------	--------------------------------------------------------------------------

Section 38 adoption sites.			
DO003037	Land at New Dover Road, Capel-le-Ferne	40 New Residential Dwellings	Works are underway.
DO003004	Old Park Hill, Dover	New Residential Dwellings	Still awaiting drawing approval.
DO003057	Phase1 Whitfield Development (Halsbury Homes) Stage 1 of 6	New Residential Dwellings	Phase 1 Works are underway. Developer is still to undertake remedial works.
DO003013	Aylesham Phase Roads 1.7 and 1.8 (off Central Boulevard, Corminster Avenue, Sunshine Corner Avenue, Suds Street)	New Residential Dwellings	Works complete. Remedial works still required.
DO003063	Aylesham Phase 1B	New Residential Dwellings	Works have started on site. Drawing approval has been given.
DO003082	Singledge Lane, new housing development.	New Residential Dwellings	Developer has started construction of road 3. But S38 adoption agreement is not currently in place.
DO003292	Former Officers site, Connaught Barracks, Dover Road. Dover. CT16 1 HL	New Residential Dwellings	Technical approval given. Work is due to start in Feb 2020. No S38 agreement is in place at this time.
DO003021	Aylesham Village Expansion West (Persimmon Homes) Phase 1a (off Dorman Avenue North and Central Boulevard)	New Residential Dwellings	Works on going.
DO003153	Woodnesborough Road, Sandwich development.	New Residential Dwellings	The developer has made an application for a S38 adoption agreement.
DO003201	Station Road, Walmer	New Residential Dwellings	Drawing approval has been given and work has started on site.

DO003236	Richmond Park, Dover. Phase 1B	New Residential Dwellings	No agreement in place.
DO003438	Dorman Avenue North connection Rd.	New Residential Dwellings	38 application received. Drawing acceptance given.
DO003432	Chequer Lane, Ash Kent	90 New Residential Dwellings	S38 application made for highway adoption.
Hi.38.104	Sandwich Industrial Estate. Phase 1A	Residential Dwellings	Developer is still working on site and further highway works are required.
DO003433	Canterbury Road, Lydden	Entrance to surgery	S38 application made for adoption of the road leading to surgery only. It does not include the new development.

Appendix F – Public Rights of Way

Public Rights of Way – Contact Officer: Matthew Fox			
Path No	Parish	Description of Works	Current Status
ER261	Alkham	Path surface significantly scoured by Highway drainage issues.	Waiting completion of drainage works before reinspection
ER38	St Margarets	England Coast Path from NT to Langdon Hole	Specification with Consultees
ER215	Hougham Without	Badly worn Coast Path	Landowner issues

Appendix G - Bridge Works

Bridge Works – contact officer Clare Willmore/David Aspinall			
Road Name	Parish	Description of Works	Current Status
A256	Sandwich	Culvert lining on South Poulders Culvert (2536) which passes beneath the A256.	Works in planning stage and consultation with the IDB. Works will not affect the carriageway. Planned for 2022

Appendix H – Traffic Systems

There is a programme of scheduled maintenance to refurbish life expired traffic signal equipment across the county based upon age and fault history. The delivery of these schemes is dependent upon school terms and holiday periods; local residents, businesses and schools will be informed verbally and by a letter drop of the exact dates when known.

Traffic Systems - Contact Officer: Toby Butler		
Location	Description of Works	Current Status
No current update.		

Appendix I – Combined Members Grant

Combined Members Grant programme update for the Dover District

The following schemes are those which have been approved for funding by both the relevant Member and by the Director of Highways, Transportation & Waste and is up to date as of **2nd March 2021**

The details below are for Highway Schemes **only** and **does not** detail contributions Members have made to other groups such as Parish and District Councils.

Further scheme details are available to Members via their Acting District Manager (Paul Valek) or Schemes Planning and Delivery Project Manager (Louise Winch).

Pauline Beresford – Dover Town

Scheme	Status
Astor Avenue, Tower Hamlets – Reconstruction of speed humps and resurfacing <i>(joint funded with Nigel Collor)</i>	Construction programmed for 21/7/2021

Nigel Collor – Dover Town

Scheme	Status
Astor Avenue, Dover – Safety Improvements, replacement/upgrade of traffic calming measures	In design

Steve Manion – Dover North

Scheme	Status

Geoff Lymer – Dover West

Scheme	Status

Trevor Bond – Deal & Walmer

Scheme	Status
Bus Shelter, London Road, Sholden (opposite the Fire Station)	Construction programmed for 15/3/2021
Formalisation of existing bus stop on Main Road, Sholden	Construction after Pre-election Period (Date TBC)

Derek Murphy – Deal & Walmer

Scheme	Status
Installation of Build-out and uncontrolled crossing point on A258 Dover Road north of junction with Herschell Road East	Construction Programmed for 8/3/2021
Redsull Avenue, Sholden – junction	COMPLETE

improvements	
--------------	--

Sue Chandler - Sandwich

Scheme	Status

Appendix J – Street Works

Please note that this list is accurate at the time of running the report and is subject to cancellations and additions.

Report highlighting all works in Dover District that require road closures with a duration of 5+ days.

For information on all progress and proposed works please visit <https://one.network/>

STREET	TOWN	WORKS PROMOTER	WORKSDESC	EST. DATES
LOWER STREET	EASTRY	KCC	Strengthening of carriageway - Plane existing carriageway to a depth of 80mm and inlay new binder and surface course	01/04/2021-30/03/22
WOODNESBOROUGH ROAD	SANDWICH	KCC	Strengthening of carriageway - Plane existing carriageway to a depth of 80mm and inlay new binder and surface course	01/04/2021-20/03/22
WOODNESBOROUGH ROAD	SANDWICH	KCC	Strengthening of carriageway - Plane existing carriageway to a depth of 80mm and inlay new binder and surface course	31/03/2021-31/03/22
GUSTON ROAD	EAST LANGDON	AFFINITY WATER	Valve works	12/04/2021-16/04/21
MONGEHAM ROAD	GREAT MONGEHAM	KCC	KCC Surface Dressing 2021	TBC. 05/07/21 & 28/08/21
THORNTON LANE	TILMANSTONE	KCC	Carriageway Patching Permanent Potholes repairs	22/03/2021-26/03/21
FELDERLAND LANE	WORTH	SGN	LAY NEW SERVICE FROM F/S C/WAY TO SITE = 6m	10/05/2021-14/05/21
PADBROOK LANE	ELMSTONE	KCC	Carriageway Overlay repairs and replacment lining	15/03/2021-19/03/21
SINGLEGE LANE	WHITFIELD	KCC	CW patching repairs	15/03/2021-19/03/21

1.1 Legal Implications

1.1.1 Not applicable.

1.2 Financial and Value for Money Considerations

1.2.1 Not applicable.

1.3 Risk Assessment

1.3.1 Not applicable.

Contacts: Stephanie Wadhams/Toby Howe 03000 418181

DOVER DISTRICT COUNCIL

REPORT OF THE STRATEGIC DIRECTOR (OPERATIONS AND COMMERCIAL)

DOVER JOINT TRANSPORTATION ADVISORY BOARD – 18 MARCH 2021

PROPOSED RESIDENTS' PARKING SCHEME FOR HEWITT ROAD AND GOODFELLOW WAY, DOVER

Recommendation:

The Board is asked to recommend:

That the proposed residents' parking scheme detailed in this report and shown in Appendix A be withdrawn.

Contact Officer: Gordon Measey

1. Some residents in Hewitt Road and Goodfellow Way had asked for a residents' parking scheme to be considered for their roads. There is already a residents' on-street scheme operating in Dour Street (the main road frontage), but it does not include the above two spur roads.
2. An informal consultation was undertaken with the residents in Dour Street, Hewitt Road and Goodfellow Way. A copy of the map, letter and questionnaire sent to the residents are attached as Appendices A, B and C to this report.
3. The results of those that responded to the survey are shown below:

Support for or against the extension of the on-street Zone F residents' parking to extend in to Hewitt Road and Goodfellow Way?

ROAD	SUPPORTED	NOT SUPPORTED
Dour Street	4	9
Hewitt Road	3	3
Goodfellow Way	2	1

Support for or against the creation of residents' parking covering the private parking areas at the end of Hewitt Road and Goodfellow Way?

ROAD	SUPPORTED	NOT SUPPORTED
Hewitt Road	4	4
Goodfellow Way	5	6

4. In light of a lack of majority supporting either proposal in all 3 roads (bar a single count in Goodfellow Way for just one proposal), officers feel that they don't have the mandate to progress the proposed scheme further.
5. The Board is asked to withdraw the proposal.
6. Evaluation of options available to the Board:
 - To withdraw the proposal detailed in Appendix A
 - To agree to advertise an amended proposal
 - To recommend to Kent County Council that the proposal as detailed in this report and Appendix A be sealed and brought into effect.

Background Papers

Parking Services Files

Consultation Statement

The Portfolio Holder for Transport, Licensing and Community has been consulted on the proposal outlined in this report.

Attachments

Appendix A	Map showing Proposed Residents' Parking Scheme
Appendix B	Letter sent to Residents
Appendix C1 and C2	Questionnaire sent to Residents
Appendix D	Summary of Key Points Raised by Responders

ROGER WALTON

Strategic Director (Operations & Commercial)

The officer to whom reference should be made concerning inspection of the background papers is the Parking Operations Manager, Dover District Council, White Cliffs Business Park, Dover, Kent CT16 3PJ. Telephone: (01304) 821199, Extension 42422

Proposed extent of new Zone F Residents Parking Scheme

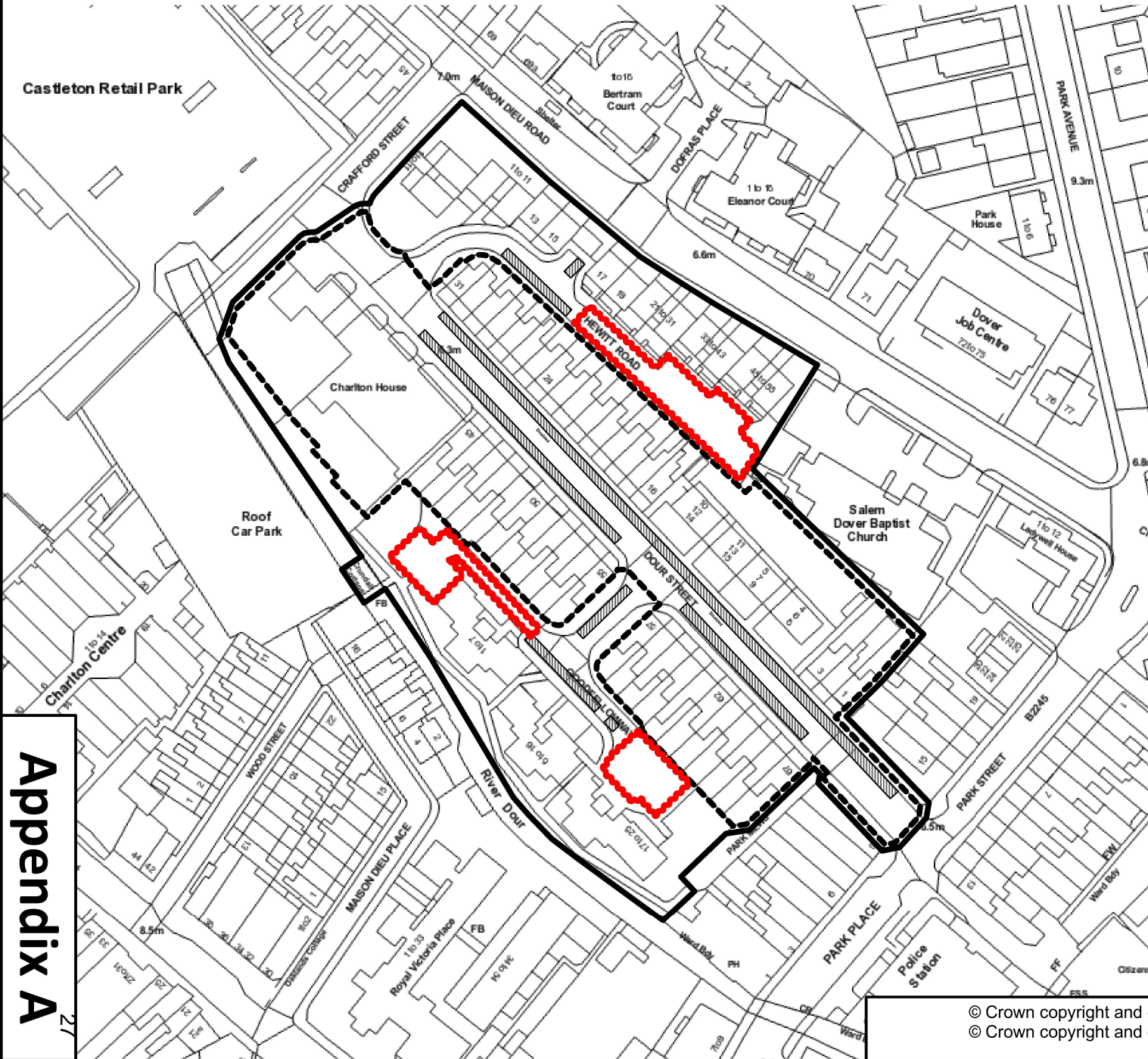

KEY FOR MAP:



 Existing extent of Zone F Residents Parking Scheme (Dour Street only).

 Proposed enlarged Zone F Residents Parking Scheme, to include Dour Street, Hewitt Road and Goodfellow Way.

 Private parking for Hewitt Road & Goodfellow Way residents.

 Extent of Parking Bays, including existing Disabled bays.

Double Yellow Lines (Prohibition of Parking) to cover all other sections of roads within the zone.

 **Mon - Sat**
8.30 am - 5.30 pm
Permit holders 
or
2 hours
No return within 4 hours

Proposed restriction, as shown on sign.
Posts with signs required on the footpath adjacent to white marked parking places.

Scale: 1:1000 Date: January 2021 Drawn by: DA



Prepared By:
Operations & Commercial Division
Eurling Roger Walton, C. Eng. M. I. C. E
Strategic Director
Dover District Council
Honeywood Close
White Cliffs Business Park
Whitfield
DOVER
CT16 3PJ



Appendix A

Appendix B

Parking Services
Dover District Council
White Cliffs Business Park
Dover
Kent CT16 3PJ

Telephone: (01304) 872008
Fax: (01304) 872445
DX: 6312
Minicom: (01304) 820115
Website: www.dover.gov.uk/parking

Contact: Ms. S Young
Direct line: (01304) 821199
Email: parking-onstreet-consultation@dover.gov.uk
Our ref: RH/SCY/Goodfellow/Hewitt
Your ref:
Date: 19th February 2021

THIS IS NOT A CIRCULAR

«F1» «F2»
«F3»
«F4»

Dear Sir or Madam,

Proposed residents' parking scheme – Goodfellow Way and Hewitt Road, Dover

Following our previous letter to you, we have been made aware that there has been some confusion regarding the Scheme, and I do apologise for any concerns you may have had. We are now giving you a further opportunity to respond.

We are aware that non-residents regularly park along the roads in your neighbourhood and, of those, most of them stay for the full working day or park in the evenings reducing parking availability for the residents. One possible way to address this problem that has been suggested by some residents would be to introduce a “residents only” parking scheme into both areas; these will respectively be known as Zone S for Goodfellow Way and Zone T for Hewitt Road.

I am therefore writing to enquire whether, you would support the introduction of a “residents only” parking scheme in your road?

Please find enclosed a plan showing the extent of the residential parking schemes Zone S & Zone T being proposed for your areas. The schemes, if progressed, would involve introducing permits for all residents. Households within the zones can apply for up to 2 annual permits per household; the cost of the permits are now based on the emission level of a vehicle and are shown below. The purchase of a permit does not guarantee the availability of parking spaces. You would not be eligible to park in either Zone, just the Zone specific to your address, i.e. Zone S for Goodfellow Way residents and Zone T for Hewitt Road residents.

Residents are also permitted to purchase Visitor Tickets for guests, which will allow your guests to park in the “residents only” areas of Goodfellow Way or Hewitt Road. These currently cost £22.00 for a book of 10 tickets. However, from 1st April 2021, these will cost £30 for a book of 10. One has to be given to each guest for them to display in their car during their visit to you. For residents with more than one vehicle per household, you can have 2 vehicles on the one permit, but only one vehicle at a time can be active on the permit, but you can swap between vehicles depending which vehicle is required to park. Where two registration numbers are required on the one permit, the cost for the second vehicle will be based on the vehicle with the highest emissions.

If the majority of responders support the proposed schemes, agreement will be sought from Councillor's on the Dover Joint Transportation Advisory Board (JTAB) to formally advertise the proposal. Conversely, if the majority of responders' object, it is likely that the JTAB will abandon the proposal. Alternatively, if all but one or two roads support the scheme, it's possible that a variant scheme could be considered that excludes those roads where the majority of responders objected.

Yours faithfully,



Ms. R. Hafizi

Transport and Parking Services Manager

Charges to be based on vehicle emissions, first vehicle cost:

C02: 0: £35
1-50: £70
51-130: £90
>130: £110

Charges to be based on vehicle emissions, second vehicle cost:

C02: 0: £60
1-50: £85
51-130: £115
>130: £135

Appendix C1

Proposed Residents' Parking Scheme, Dover – Zone S and Zone T

Goodfellow Way & Hewitt Road, Dover

Please fill in your name and address below:

Name: _____

Address: _____

Please tick (✓) the appropriate boxes below

1. Do you have use of any off street parking (e.g. a garage or hard standing)?

Yes	No
<input type="checkbox"/>	<input type="checkbox"/>

2. Having considered the proposal, would you support the introduction of the “residents’ only” parking scheme as detailed in the accompanying documents?

Yes	No	(If No , please state reason below):
<input type="checkbox"/>	<input type="checkbox"/>	<div style="border: 1px solid black; height: 40px;"></div>
	Other	(If Other , please state reason below):
	<input type="checkbox"/>	<div style="border: 1px solid black; height: 40px;"></div>

Additional Comments: _____

Thank you for completing this form. Please return it to the Parking Services Team at Dover District Council, as detailed in the covering letter, by **Friday 5th March 2021**

Appendix C2

Extension to current Zone F Permit Scheme

Please fill in your name and address* below:

(*Any replies sent without name and address details will not be considered in the results.)

Name: _____

Address: _____

Please tick (✓) the appropriate boxes below

1. Do you agree to the extension of the current Zone F scheme shown in orange on the attached map?

Yes	No
<input type="checkbox"/>	<input type="checkbox"/>

2. Are you a current Zone F permit holder?

Yes	No
<input type="checkbox"/>	<input type="checkbox"/>

Additional Comments: _____

Thank you for completing this form. Please return it to the Parking Services Team at Dover District Council, as detailed in the covering letter, by Friday 5th February 2021.

Summary of Key Points Raised by Responders

(Proposed Extension to Zone F & addition of new 'Resident Only' Zones in Goodfellow Way and Hewitt Road)

Response to proposals to Zone F: Objections 13, Support 9

Key points raised by Objectors:

- No, but no comment
- No, but no comment
- No, but no comment
- Can park OK. Not a problem.
- Not fair, why should residents have to pay? 4hr l/w is unfair when HGV's park overnight, sometimes with refrigeration unit running.
- Residents of Dour Street park in Hewitt Road so as not to purchase a permit. They also repair vehicles and obstruct emergency service vehicles.
- Visitors are unable to park for long. This is pandering to the wishes of the minority instead of listening to the whole community.
- I have rear access to Goodfellow and do not find parking a problem.
- Keep Goodfellow for residents parking only.
- As Dour Street is now a lorry park, why should we pay to park? Lorries park for free overnight with refrigeration units running.
- My wife is disabled. When are you going to stop Port traffic using Dour Street as a lorry park?
- Has back entrance to parking area and there are generally 8 spaces there, so no problem with parking, why does it have to change?
- I am against it.

Key points raised by Supporters:

None

'Resident Only' Zones

Response to proposals: Objections 10, Support 2

Key points raised by Objectors:

- Private land get a company in to patrol at no cost to Council or residents.
- Does not agree, do not wish to purchase visitor tickets; The entrance to Goodfellow Way which is not covered is always parked on and hard to pass why cannot that part of Goodfellow Way also be restricted to residents only.
- We do not have a car, "BUT" if a family/friend visit (max stay usually approx. 1 hour) why on earth should we have to pay for this, absolutely abused. Please leave the facility as it is most of the residents are pensioners and these charges are unjust. park.
- I have lived here for 6 years and NOT once have I had trouble parking. I park in the parking near my flat NO problem at all. If you are proposing to go through with this why is it not charged on the SIZE of the vehicle and not on the omissions as I have seen massive cars parked with no C02 and tiny high-powered ones.
- Not able to afford to pay for a permit. Sorry, plus I rely on my visitors. I live on my own my carers and visitors come regularly I could not afford these fees. My family come 1-2 times a year normally from the North so buying tickets would be unhelpful to me.
- Do not believe the Council to park outside home. It is now 10.15am and there are 8 empty spaces. I see no reason to pay the Council, for what, we do not even get a road sweeper once a week.
- Main problem is Dour Street residents parking in Hewitt Rd. Why should Hewitt residents pay to park?
- Shouldn't have to pay to park outside our home and we never see a road sweeper. It is now 10.15am and there are 8 empty spaces.
- It will be impossible to enforce. I cant see it working. People live in Dour Street park in Hewitt Road and people who work in town park unless you get gates it wont work.
- Never had any problem parking ever. Another tax on the poor. How can we pay this we are on disability benefits and need the car because we cant walk far, this is a cruel, unnecessary and be detrimental to our physical and mental wellbeing.

Key points raised by Supporters:

- And to make it 24hrs and if you don't have a car you can't pay for your granddaughters to park.
- I work full time and start work early in the morning and other times I finish work at 10pm. I would feel safer to be able to park in our car park of Goodfellow Way. So, residents only is/would be welcome and feel safe. Ladywell House flats have resident private parking so Goodfellow Way should too. We are an ageing community some residents have mobility and health issues. Parking close to home would benefit them to.

DOVER DISTRICT COUNCIL

REPORT OF THE STRATEGIC DIRECTOR (OPERATIONS AND COMMERCIAL)

DOVER JOINT TRANSPORTATION ADVISORY BOARD – 18 MARCH 2021

PROPOSED RESIDENTS’ PARKING SCHEME FOR HAROLD STREET AREA, DOVER

Recommendation:

The Board is asked to note the report.

Contact Officer: Gordon Measey

1. An informal consultation was undertaken with residents in the Harold Street area in Dover to see how much support there was for a proposed residents’ parking scheme.
2. The roads surveyed were:
 - Castlemount Road
 - Leyburne Road
 - Harold Street
 - Godwyne Road
 - Godwyne Close
 - Taswell Street
 - Taswell Close
3. A copy of the letter, questionnaire and map sent to the residents are attached as Appendices A, B and C to this report.
4. The results of those that responded to the survey are shown below:

ROAD	SUPPORTED	NOT SUPPORTED
Castlemount Road	6	14
Godwyne Road	6	9
Godwyne Close	8	8
Harold Street	22	16
Leyburne Road	18	14
Taswell Close	5	1
Taswell Street	7	1

5. In light of the responses received, Parking Services will formally advertise a slightly smaller residents’ parking scheme covering those roads where the majority of

responders supported the scheme, leaving out Castlemount Road, Godwyne Road and Godwyne Close.

6. The results of the formal advertisement will be brought back to a future meeting of the Board to make its recommendation.
7. The Board is asked to note the report.

Background Papers

Parking Services Files

Consultation Statement

The Portfolio Holder for Transport, Licensing and Community has been consulted on the proposal outlined in this report.

Attachments

- Appendix A Map showing extent of originally proposed residents' parking scheme
- Appendix B Letter sent to residents
- Appendix C Questionnaire sent to residents

ROGER WALTON

Strategic Director (Operations & Commercial)

The officer to whom reference should be made concerning inspection of the background papers is the Parking Operations Manager, Dover District Council, White Cliffs Business Park, Dover, Kent CT16 3PJ.
Telephone: (01304) 821199, Extension 42422

Proposed Extent of new Zone R Residents Parking Scheme

KEY TO MAP;



Extent of proposed new Zone R to include Godwyne Road, Godwyne Close, Castlemount Road, Leyburne Road, Harold Street, Taswell Street and Taswell Close

P Mon - Sat
8.30 am - 5.30 pm
Permit holders **R**
or
2 hours
No return within 4 hours

Proposed restriction, as shown on sign
Posts with signs required on the footpath adjacent to marked parking places



Prepared By:
Operations & Commercial Division
Euring Roger Walton, C. Eng. M. I. C. E
Strategic Director
Dover District Council
Honeywood Close
White Cliffs Business Park
Whitfield
DOVER
CT16 3PJ

Scale: 1:1,600
Drawn by: DA

Date: January 2021

© Crown copyright and database rights 2020 Ordnance Survey 100019614
© Crown copyright and database rights 2020 Ordnance Survey 100019780

Appendix A

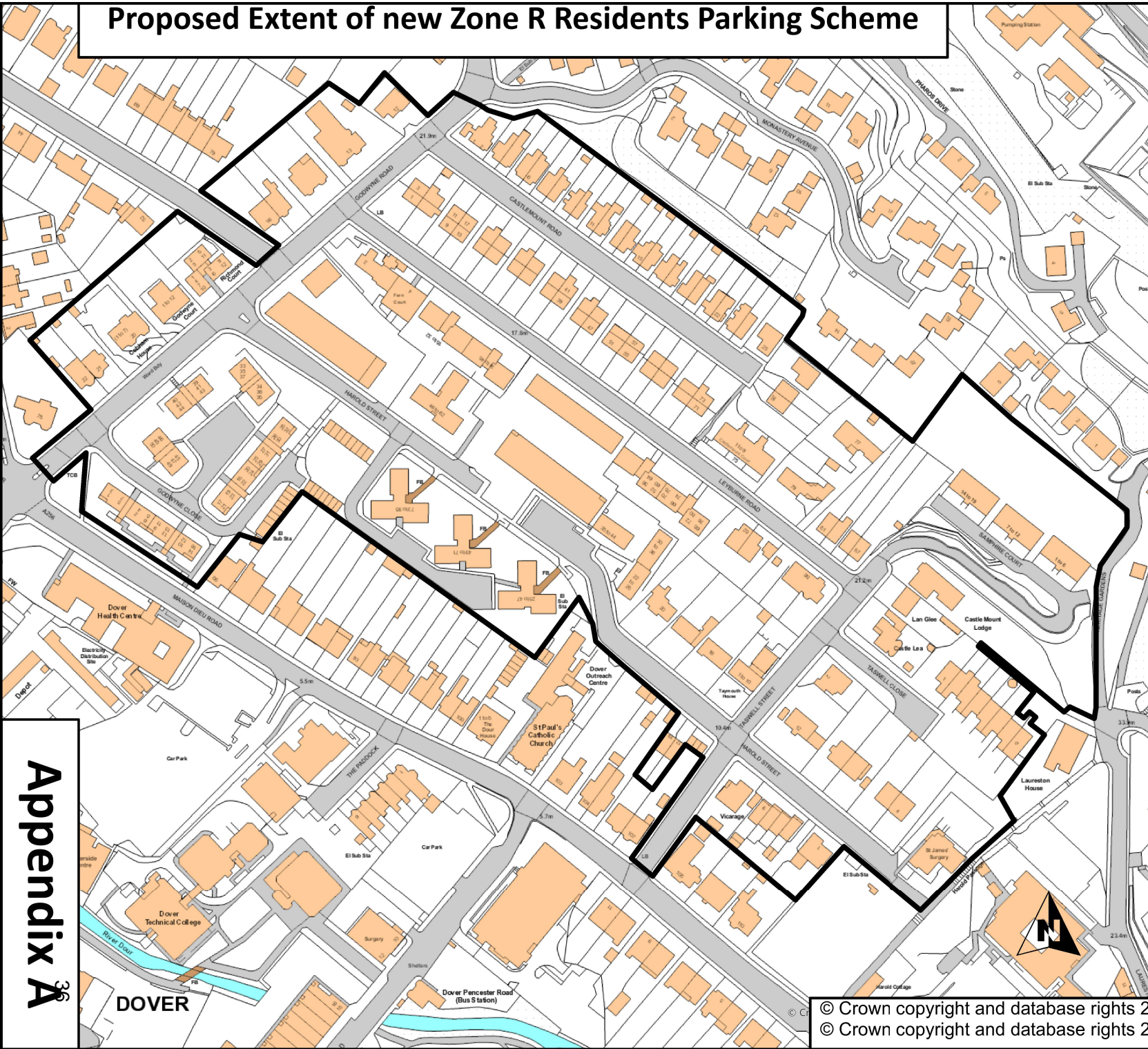

DOVER

Parking Services
Dover District Council
White Cliffs Business Park
Dover
Kent CT16 3PJ

Telephone: (01304) 872008
Fax: (01304) 872445
DX: 6312
Minicom: (01304) 820115
Website: www.dover.gov.uk/parking

THIS IS NOT A CIRCULAR

Owner/Occupier

Contact: Mr. D. Aldridge
Direct line: (01304)) 872796
Email: parking-onstreet-consultation@dover.gov.uk
Our ref: RPS/PS18/2020
Your ref:
Date: 7th January 2021

Dear Sir or Madam,

Proposed residents' parking scheme – Godwyne Road, Castlemount Road, Godwyne Close, Harold Street, Leyburne Road, Taswell Street and Taswell Close

Following our previous letter to you, we have been made aware that some people encountered problems with the email address. This has been rectified and we are, therefore, giving those that did experience problems, a further opportunity to respond. Those of you that have emailed or posted a response, do not need to reply again.

We are aware that non-residents regularly park along the roads in your neighbourhood and, of those, most of them stay for the full working day. One possible way to address this problem that has been suggested by some residents would be to introduce a residents' parking scheme.

I am therefore writing to enquire whether, you would support the introduction of a residents' parking scheme along your road?

Please find enclosed a plan showing the extent of the residential parking scheme (Zone R) being proposed for your area. The scheme, if progressed, would involve introducing a limit of 2 hours parking (return prohibited for 4 hours) along the roads within the zoned area. The limited waiting restriction would apply during the working day (8.30am – 5.30pm, Mon – Sat) but not in the evenings, nor on Sundays. Vehicles displaying the Zone R Resident Permits would be exempt from the 2-hour limit but, all other vehicles would need to comply with the Monday to Saturday daytime limit. Households within the zone can apply for up to 2 annual permits per household: the first one costing £65 p.a. and the second £90 p.a. The purchase of a permit does not guarantee the availability of parking spaces.

To help gauge the views of residents, could you please indicate your preference for, or against, the proposed residents' parking scheme by filling in and returning the enclosed questionnaire, to reach this office by 12noon on Friday 29th January 2021. Alternatively, you can reply via email to: parking-onstreet-consultation@dover.gov.uk stating whether, or not, you support the proposed scheme. Please ensure that any emails are delivered by 12noon on Friday 29th January 2021, and that they include your name and postal address.

If the majority of responders support the proposed scheme, agreement will be sought from Councillor's on the Dover Joint Transportation Advisory Board (JTAB) to formally advertise the proposal. Conversely, if the majority of responders' object, it is likely that the JTAB will abandon the proposal. Alternatively, if all but one or two roads support the scheme, it's possible that a variant scheme could be considered that excludes those roads where the majority of responders objected.

Yours faithfully,



Mr. Dean Aldridge
Parking Operations Officer

Appendix B

37

Proposed Residents' Parking Scheme, Dover – Zone R

Godwyne Road, Godwyne Close, Harold Street, Taswell Close, Taswell Street, Leyburne Road, and Castlemount Road, Dover

Please fill in your name and address below:

Name: _____

Address: _____

Please tick (✓) the appropriate boxes below

1. Do you have use of any off-street parking (e.g. a garage or hard standing)?

Yes	No
<input type="checkbox"/>	<input type="checkbox"/>

2. How many vehicles do you regularly park in yours or neighbouring streets?

0	1	2	3 or more
<input type="checkbox"/>	<input type="checkbox"/>	<input type="checkbox"/>	<input type="checkbox"/>

3. Having considered the proposal, would you support the introduction of the residents' parking scheme as detailed in the accompanying documents?

Yes	No (If No , please state reason below):
<input type="checkbox"/>	<input type="checkbox"/> _____

Other (If Other , please state reason below):
<input type="checkbox"/> _____

Additional Comments: _____

Thank you for completing this form. Please return it to the Parking Services Team at Dover District Council, as detailed in the covering letter, by **12 noon on Friday 29th January 2021**

DOVER DISTRICT COUNCIL

REPORT OF THE STRATEGIC DIRECTOR (OPERATIONS AND COMMERCIAL)

DOVER JOINT TRANSPORTATION ADVISORY BOARD – 18 MARCH 2021

PROPOSED ELECTRIC VEHICLE CHARGING POINT PROVISION

Recommendation:

The Board is asked to:

Recommend that any of the proposed electric vehicle charging bay sites detailed in this report that do not receive any objections in response to the advertised Traffic Regulation Order (TRO) be sealed by Kent County Council (or Dover District Council in the case of car parks) in order to bring them into effect.

(Any sites receiving objections will be referred to a future meeting of this Board for further consideration, prior to it making any final recommendations).

Contact Officer: Gordon Measey

1. Dover District Council has secured funding approved by the Office of Zero Emission Vehicles for the provision of 49 electric vehicle (EV) charging points at various sites across the district as detailed in the two tables below.

OFF-STREET (CAR PARKS)	
LOCATION	EV SPACES
Bench Street, Dover	4
Albany Place, Dover	2
Maison Dieu Road, Dover	4
Union Road, Deal	2
Middle Street, Deal	3
West Street, Deal	4
Royal Marines Memorial, Walmer	2
Guildhall, Sandwich	3
The Quay	4
Gazen Salts, Sandwich	4

ON- STREET (ROADS)	
LOCATION	EV SPACES
Folkestone Road, Dover	2
Park Street, Dover	2
Waterloo Crescent, Dover	3
Lewisham Road, River	2
The Strand, Walmer	2
Victoria Road, Deal	2
High Street, Deal	2
New Street, Sandwich	2

2. The proposed on-street locations are shown on the maps in Appendices A1 – A8 attached to this report.
3. The provision of the charging points is to promote the use of electric vehicles and to ensure that on-street parking is not a barrier to owning a plug-in electric vehicle.
4. As part of the process, Traffic Regulation Orders (TROs) are required for the new EV charging spaces for enforcement purposes ensuring that only electric vehicles on charge can use the allocated spaces. The proposed TROs are currently being formally advertised. Some objections may be received and more likely for the on-street locations rather than those in the car parks.
5. The Board is asked to recommend, for any of the sites that receive no objections to the formal consultation, that the TROs for these be sealed to bring them into effect.
6. Any sites receiving objections to the formal consultation will be referred to the Board at its next meeting on June 10 June 2021, for further consideration prior to it making any final recommendation.
7. Evaluation of options available to the Board:
 - To agree to recommendation in this report
 - To amend the recommendation in this report

Background Papers

Parking Services Files

Consultation Statement

The Portfolio Holder for Transport, Licensing and Community has been consulted on the proposal outlined in this report.

Attachments

Appendices A1 – A8 Proposed On-Street Electric Vehicle Charging Spaces

ROGER WALTON

Strategic Director (Operations & Commercial)

The officer to whom reference should be made concerning inspection of the background papers is the Parking Operations Manager, Dover District Council, White Cliffs Business Park, Dover, Kent CT16 3PJ. Telephone: (01304) 821199, Extension 42422

Proposed EV Charging Points Folkestone Road, Dover.

KEY FOR MAP:



Position of proposed new Electric Vehicle Charging Bay



Dual Port Charging Point

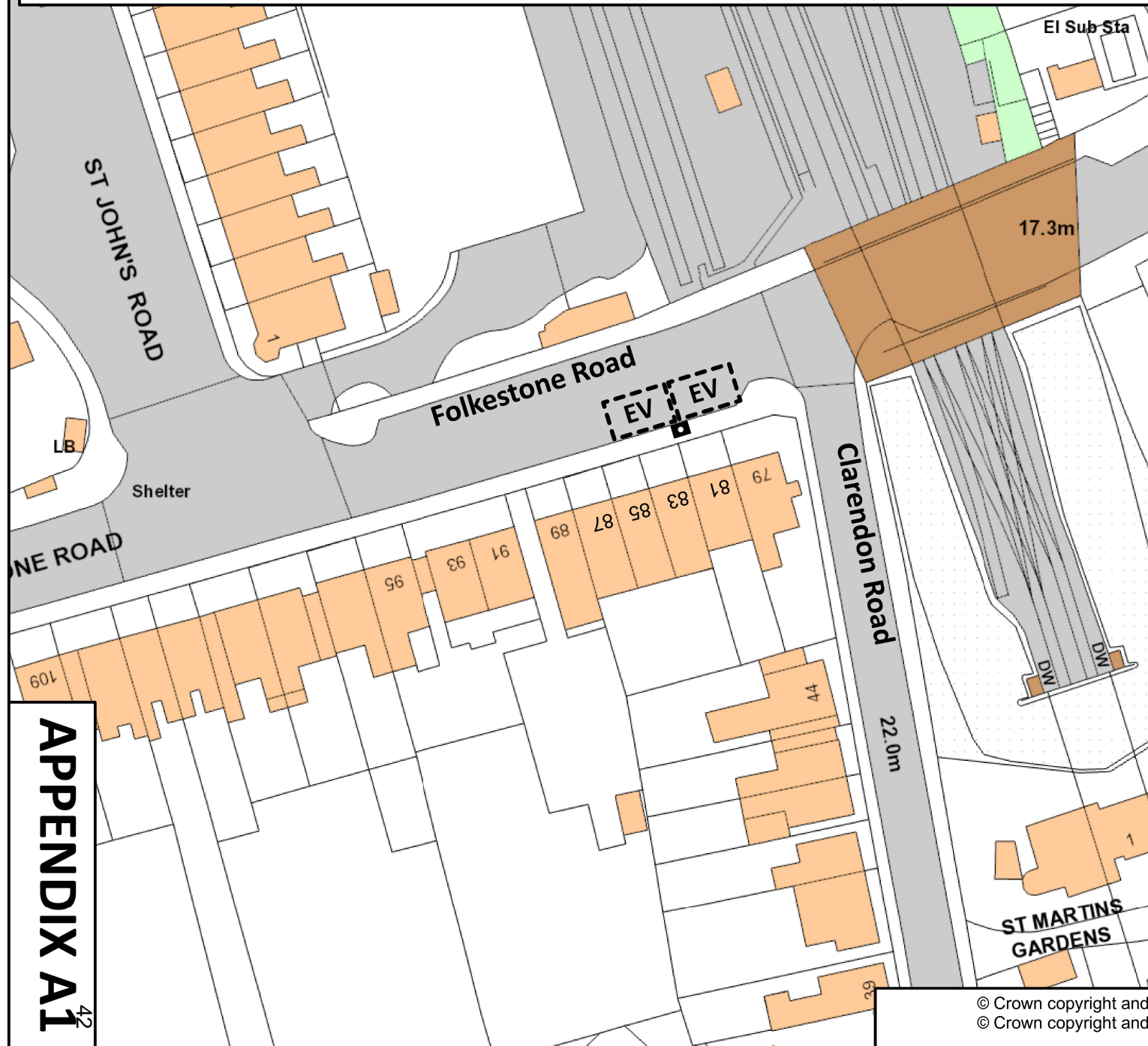

Scale: 1:500 Date: February 2021 Drawn by: DA



Prepared By:

Operations & Commercial Division
 Eurling Roger Walton, C. Eng. M. I. C. E
 Strategic Director
 Dover District Council
 Honeywood Close
 White Cliffs Business Park
 Whitfield
 DOVER
 CT16 3PJ



© Crown copyright and database rights 2020 Ordnance Survey 100019614
 © Crown copyright and database rights 2020 Ordnance Survey 100019780

APPENDIX A1
 42

Proposed EV Charging Points River, Dover.

KEY FOR MAP:



Position of proposed new Electric Vehicle Charging Bays



Dual Port Charging Point

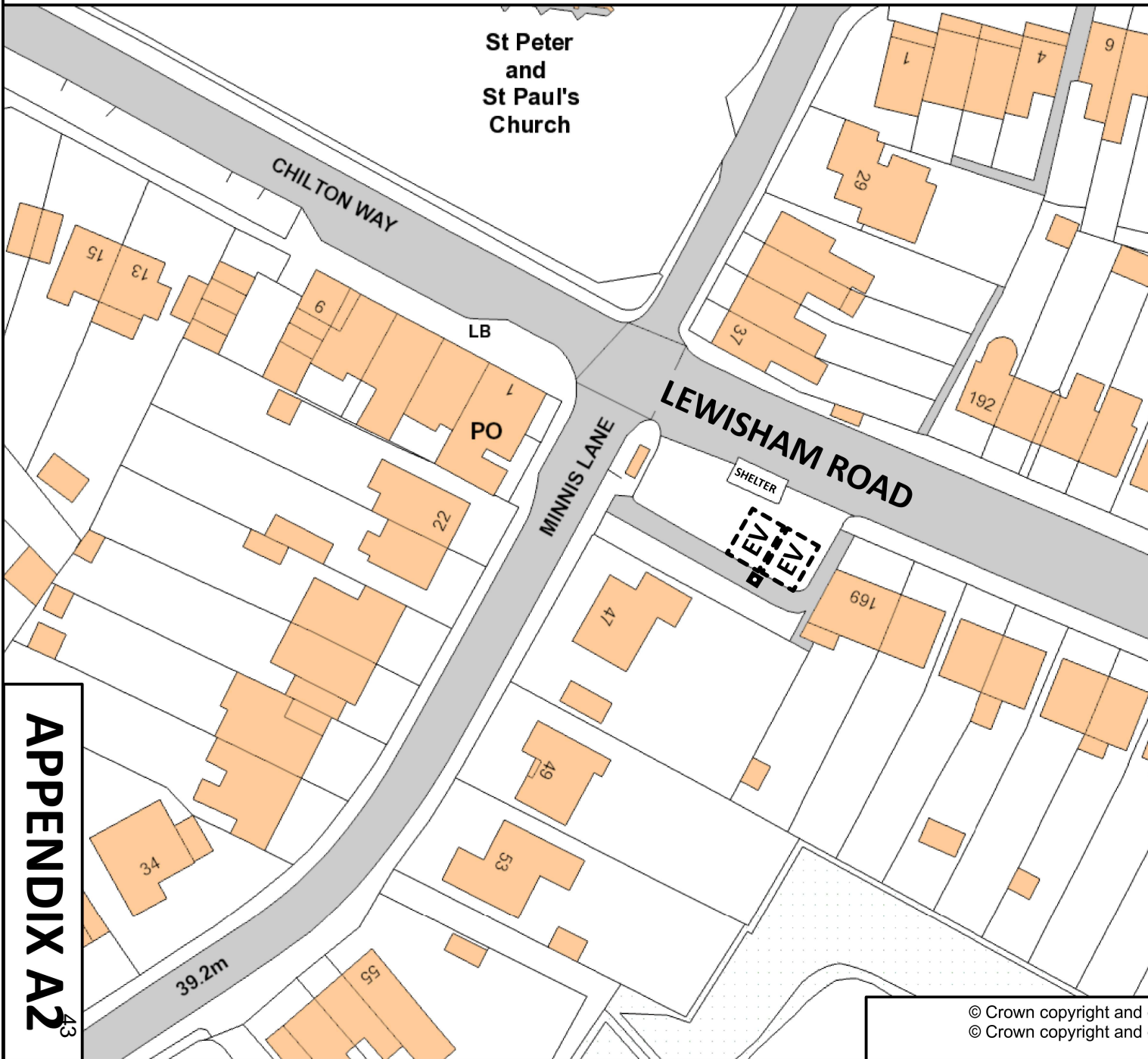

St Peter and St Paul's Church

CHILTON WAY

LB

PO

MINNIS LANE

LEWISHAM ROAD

SHELTER

39.2m

APPENDIX A2

Scale: 1:500 Date: February 2021 Drawn by: DA



Prepared By:
Operations & Commercial Division
Eurling Roger Walton, C. Eng. M. I. C. E
Strategic Director
Dover District Council
Honeywood Close
White Cliffs Business Park
Whitfield
DOVER
CT16 3PJ



© Crown copyright and database rights 2020 Ordnance Survey 100019614
© Crown copyright and database rights 2020 Ordnance Survey 100019780

Proposed EV Charging Points Park Place, Dover.

KEY FOR MAP:



Position of proposed new Electric Vehicle Charging Bay



Dual Port Charging Point

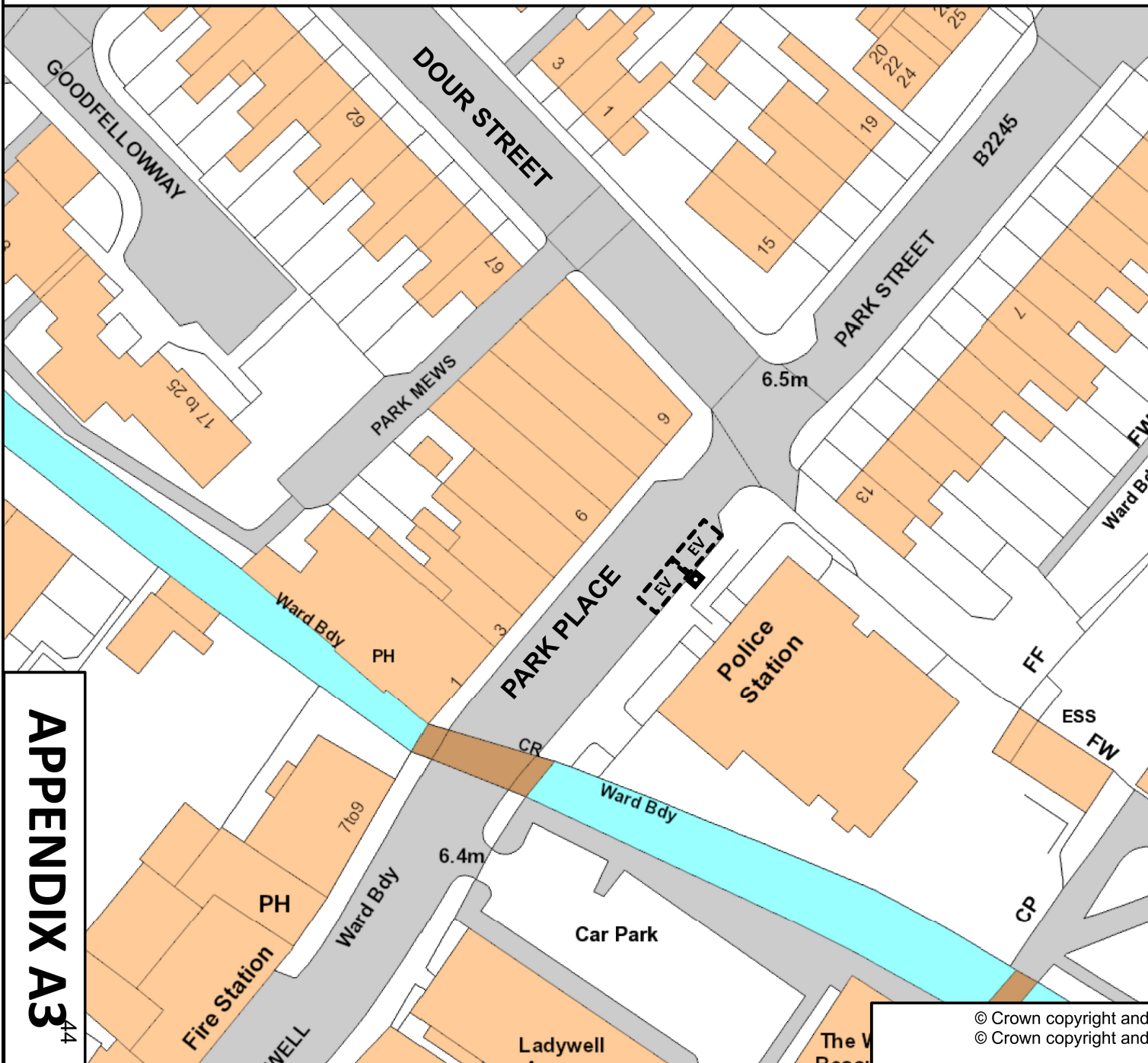

Scale: 1:500 Date: February 2021 Drawn by: DA



Prepared By:
 Operations & Commercial Division
 Eurling Roger Walton, C. Eng. M. I. C. E
 Strategic Director
 Dover District Council
 Honeywood Close
 White Cliffs Business Park
 Whitfield
 DOVER
 CT16 3PJ



© Crown copyright and database rights 2020 Ordnance Survey 100019614
 © Crown copyright and database rights 2020 Ordnance Survey 100019780

Proposed EV Charging Points Waterloo Crescent.

KEY FOR MAP:



Position of proposed new Electric Vehicle Charging Bay



Single Port Charging Point



Double Port Charging Point

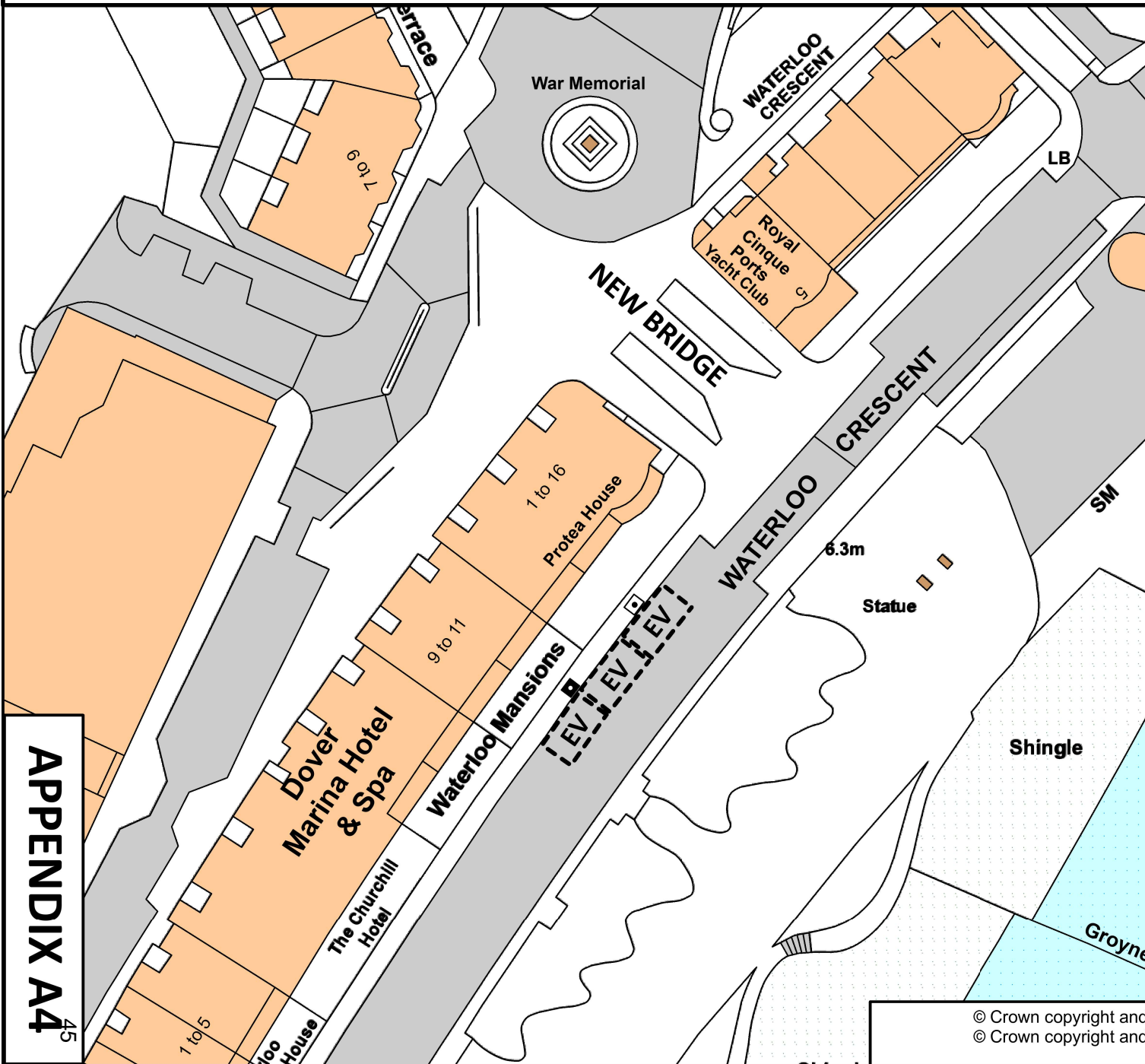

Scale: 1:500 Date: February 2021 Drawn by: DA



Prepared By:
 Operations & Commercial Division
 Eur/ing Roger Walton, C. Eng. M. I. C. E
 Strategic Director
 Dover District Council
 Honeywood Close
 White Cliffs Business Park
 Whitfield
 DOVER
 CT16 3PJ



© Crown copyright and database rights 2020 Ordnance Survey 100019614
 © Crown copyright and database rights 2020 Ordnance Survey 100019780

Proposed EV Charging Points The Strand, Deal.

KEY FOR MAP:



Position of proposed new Electric Vehicle Charging Bay



Dual Port Charging Point



APPENDIX A5

Scale: 1:500 Date: February 2021 Drawn by: DA



Prepared By:
 Operations & Commercial Division
 Eurling Roger Walton, C. Eng. M. I. C. E
 Strategic Director
 Dover District Council
 Honeywood Close
 White Cliffs Business Park
 Whitfield
 DOVER
 CT16 3PJ



© Crown copyright and database rights 2020 Ordnance Survey 100019614
 © Crown copyright and database rights 2020 Ordnance Survey 100019780

Proposed EV Charging Points Victoria Road, Deal.

KEY FOR MAP:



Position of proposed new Electric Vehicle Charging Bay



Duel Port Charging Point

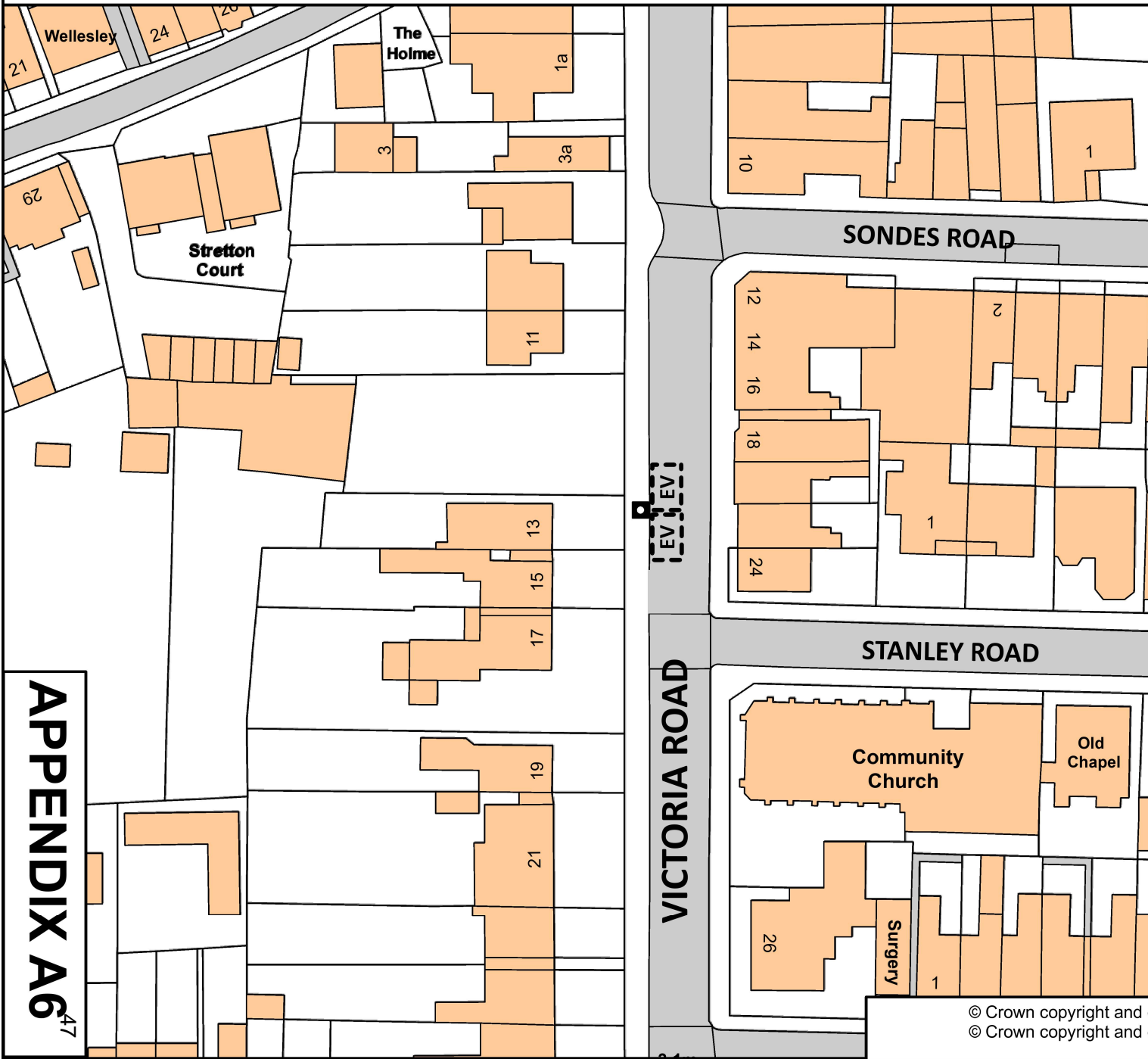

APPENDIX A6⁴⁷

Scale: 1:500 Date: February 2021 Drawn by: DA



Prepared By:
 Operations & Commercial Division
 Eurling Roger Walton, C. Eng. M. I. C. E
 Strategic Director
 Dover District Council
 Honeywood Close
 White Cliffs Business Park
 Whitfield
 DOVER
 CT16 3PJ



© Crown copyright and database rights 2020 Ordnance Survey 100019614
 © Crown copyright and database rights 2020 Ordnance Survey 100019780

Proposed EV Charging Points High Street, Deal.

KEY FOR MAP:



Position of proposed new Electric Vehicle Charging Bays



Dual Port Charging Point



APPENDIX A⁴⁸

Scale: 1:500 Date: February 2021 Drawn by: DA



Prepared By:
 Operations & Commercial Division
 Eurling Roger Walton, C. Eng. M. I. C. E
 Strategic Director
 Dover District Council
 Honeywood Close
 White Cliffs Business Park
 Whitfield
 DOVER
 CT16 3PJ



© Crown copyright and database rights 2020 Ordnance Survey 100019614
 © Crown copyright and database rights 2020 Ordnance Survey 100019780

Proposed EV Charging Points New Street, Sandwich.

KEY FOR MAP:



Position of proposed new Electric Vehicle Charging Bay



Single Port Charging Point

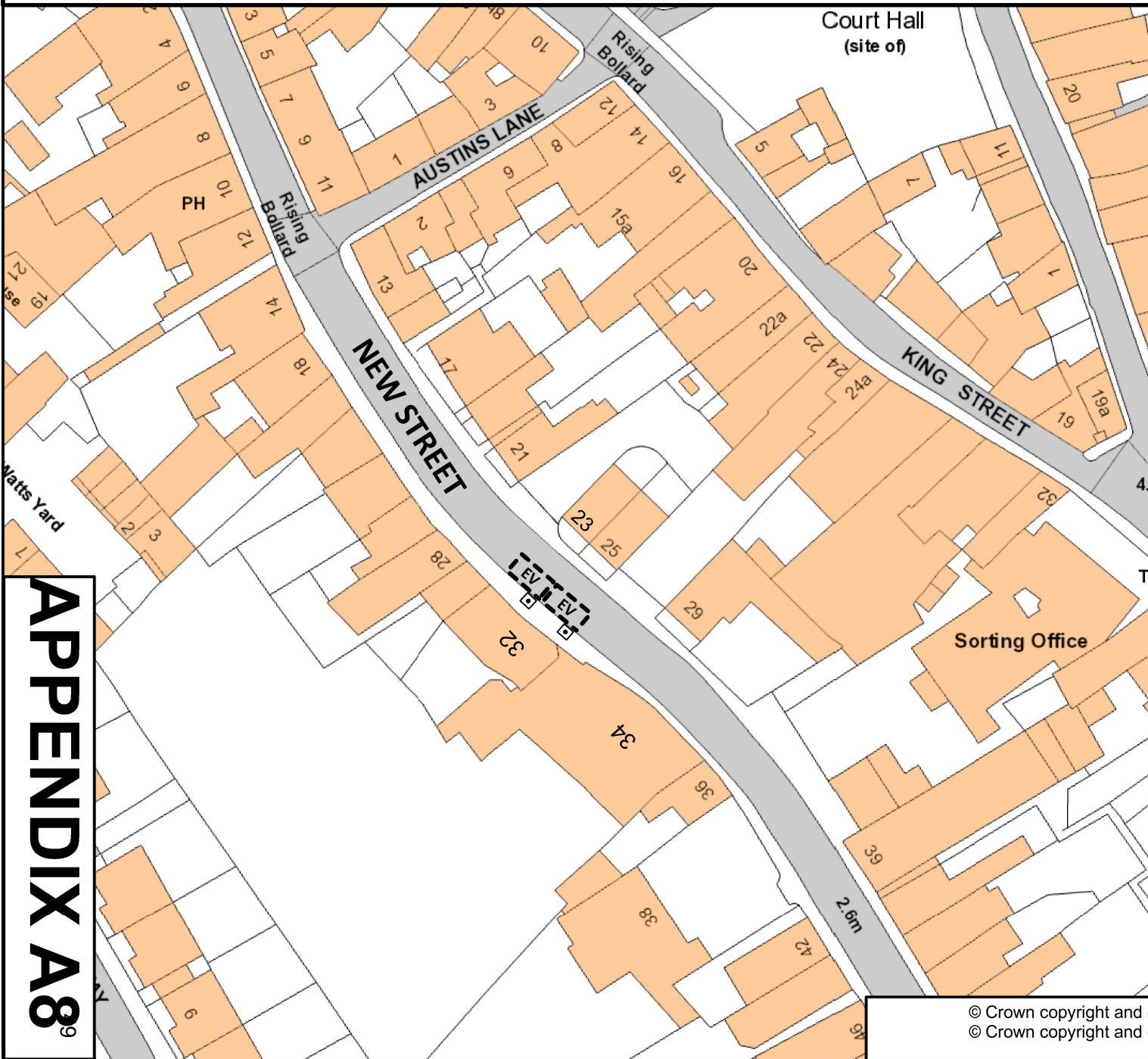

APPENDIX A8⁹

Scale: 1:500 Date: February 2021 Drawn by: DA



Prepared By:
Operations & Commercial Division
Eurling Roger Walton, C. Eng. M. I. C. E
Strategic Director
Dover District Council
Honeywood Close
White Cliffs Business Park
Whitfield
DOVER
CT16 3PJ



© Crown copyright and database rights 2020 Ordnance Survey 100019614
© Crown copyright and database rights 2020 Ordnance Survey 100019780

DOVER DISTRICT COUNCIL

REPORT OF THE STRATEGIC DIRECTOR (OPERATIONS AND COMMERCIAL)

DOVER JOINT TRANSPORTATION ADVISORY BOARD – 18 MARCH 2021

PROPOSED PARKING CHARGE INCREASE IMPLEMENTATION 2021/2022

Recommendation:

The Board is asked to:

1. Note the report; and
2. To agree delegation for Chairman and Vice-Chairman of the Board to consider any objections received in response to the advertised Traffic Regulation Orders (TROs) scheduled for April in Appendix A, on behalf of the Board and, if appropriate, to make a recommendation to Kent County Council/Dover District Council to bring them in to effect.
3. To ask the Board if it wishes to extend the same delegation to the Chairman and Vice-Chairman of the Board, as detailed above, for any other proposals in Appendix A scheduled for later in the year.

Contact Officer: Gordon Measey

1. In January 2011, it was agreed that parking charges throughout the District would be reviewed annually and in line with that decision charges have been reviewed once again.
2. Appendix A details proposed changes scheduled for the coming year and which have already been presented to and approved by the Cabinet and Overview and Scrutiny Committee.
3. Whilst most of the changes (tariff/permit changes) scheduled for April this year require a standard 21-day Notice, three of the proposed changes require Traffic Regulation Orders (TROs). This is a 21-day consultation inviting objections that need to be considered by the Board before it decides whether to recommend that KCC/DDC bring the proposals into effect. The three proposals scheduled for April that fall in this category are:
 - Middle Street Car Park, Deal – reduction of max stay from 4 hours, to 3 hours
 - Tides Car Park, Deal – introduce charging for staying beyond 4 hours
 - Albany Place Car Park, Dover – reintroduction of charging
4. As the next meeting for the Board to consider any responses to the TROs won't be until 10th June 2021 (the date is subject to confirmation at the time of writing this report), means that there will be delays to the implementation dates indicated on the schedule. One way around this would be if the Board agreed to delegate the Chairman and Vice-Chairman of the Board to consider objections on its behalf, and then to make the recommendation, if applicable, to KCC/DDC to bring the changes in to effect.
5. If the Board does not wish to delegate this role to the Chairman and Vice-Chairman, then any received objections to the advertised TROs will be reported back to the Board for consideration at its next available meeting.

6. The Board is asked to note this report and to consider the recommendations detailed at the top of this report.
7. Evaluation of options available to the Board:
 - To agree to the recommendations detailed at the top of this report
 - To amend any of the recommendations detailed in this report

Background Papers

Parking Services Files

Consultation Statement

The Portfolio Holder for Transport, Licensing and Community has been consulted on the proposal outlined in this report.

Attachments

Appendix A Proposed Parking Charge Increase Implementation Schedule
2021/2022

ROGER WALTON

Strategic Director (Operations & Commercial)

The officer to whom reference should be made concerning inspection of the background papers is the Parking Operations Manager, Dover District Council, White Cliffs Business Park, Dover, Kent CT16 3PJ. Telephone: (01304) 821199, Extension 42422

Appendix A

Parking Services

Parking Charge Increase Implementation Schedule 2021/2022

Ref.	Income Generating Proposal	Current Charges / Comments	£ Increase by	Proposed Implementation Month
1.	1 st Resident permit	£65	C02: 0: £35 1-50: £70 51-130: £90 >130: £110	April
2.	2 nd Resident permit	£90	C02: 0: £60 1-50: £85 51-130: £115 >130: £135	April
3.	Deal Zone 2 & Sandwich Zone J	£100	C02: 0: £60 1-50: £105 51-130: £125 >130: £150	April
4.	Snargate Resident & Albany Place Car Park Permit	£100	C02: 0: £60 1-50: £105 51-130: £125 >130: £150	April
5.	Resident / Car Park Permit selected Dover, Deal or Sandwich	£100	C02: 0: £60 1-50: £105 51-130: £125 >130: £150	April
6.	Daily visitor books	£22	£30	April
7.	Contractor Waivers	£12 per day, £30 per week, £65 per month	Increase to £15 per day, £35 per week, £70 per month	April
8.	Hotel Permits	£20	£25	April
9.	Minimum Charge Increase for all Off Street	40p	10p	April
10.	Sandwich – The Quay & Gazen Salts parking charge increase of 10p per tariff	Currently: - The Quay - £1.20 p/h Gazen Salts - 90p p/h	The Quay £1.30 ph Gazen Salts £1.00 ph	May
11.	Introduce Sunday Charging at Stanhope, West St, Union Road car parks	Monday to Saturday	Monday to Sunday	May
12.	Middle Street Car Park Reduce maximum stay from 4 hrs to 3 hrs			April

13.	Tides - Introduce parking charges for 4 plus hours	Currently free	Chargeable 4 hrs plus	April
14.	Albany Place - re introduce charging	Currently free	70p £1.40 £2.10 £2.80 £3.50 £4.20	April
15.	Kearsney 4 hr Max Stay		Set 4hr max stay	N/A
16.	Borrow Pit - Introduce seasonal parking charges on a cashless model 1st March - 31 st October	Cashless Payment option		May
17.	Minimum Charge Increase for all On	40p	10p	April
18.	Extend residential permit zones	Extend to 7.00am to 8pm Mon to Sat and Sundays where Sunday charging is in the car parks		June
19.	Extend P&D in New Street Sandwich		Extend P&D to all resident permit bays for non-permit holders.	June
20.	Reduce town centre limited wait bays from 2hrs to 1hr			May
21.	The Strand Walmer - Introduce cashless parking model	1hr & 2hrs Limited wait only	1hr £1.30 2 hrs £2.60	June
22.	Victoria Road - extend the P&D to both sides of street Cashless model		Charges to apply to extended area length of Victoria Road	June
23.	Marine Parade Walmer - Introduce Cashless parking charge model P&D	1hr & 2hrs Limited wait only	1hr £1.30 2 hrs £2.60	June
24.	Sondes Road, Ranelagh Road, Stanley Road, Clanwilliam Road - Introduce Cashless model parking charges	1hr & 2hrs Limited wait only	1hr £1.30 2 hrs £2.60	June
25.	ANPR at Schools	Investigate a trial		TBC

DOVER DISTRICT COUNCIL

REPORT OF THE STRATEGIC DIRECTOR (OPERATIONS AND COMMERCIAL)

DOVER JOINT TRANSPORTATION ADVISORY BOARD – 18 MARCH 2021

PROPOSED CARAVAN AND MOTOR CARAVAN PARKING RESTRICTIONS FOR DOVER SEAFRONT

Recommendation:

The Board is asked:

Whether to recommend that the parking restrictions for caravans and motor caravans detailed in this report and shown in Appendix A be brought into effect by recommending that Kent County Council seals the necessary Traffic Regulation Order.

Contact Officer: Gordon Measey

1. At its meeting on 19 September 2019, Dover Joint Transportation Advisory Board instructed officers to formally advertise a proposal (including authorisation from the Dept of Transport for highway signs) to introduce a single charge of £10 for the overnight parking of caravans and motor caravans (motor homes) along Dover Seafont, operating from 6pm – 9am, 7 days a week (cars to be excluded from overnight payment, as existing). Caravans and motor caravans will be prohibited from parking during the day (9am – 6pm).
 2. A map showing the details and extent of the restrictions that have been advertised is attached to this report as Appendix A.
 3. Of the 20 responses received to the advertised proposal:
 - 13 objected to the proposal and
 - 3 supported the proposal
 - 4 submitted comments
- Dover Town Council supported the proposal.
4. A summary of key points from responders is attached to this report as Appendix B. All the received responses are available for Members to view by prior arrangement with the Parking Services Team.
 5. The Board is asked to consider whether the proposal detailed in this report and shown in Appendix A be brought into effect by recommending that Kent County Council seals the necessary Traffic Regulation Order.
 6. Evaluation of options available to the Board:
 - To agree to recommend to Kent County Council that the proposal as detailed in this report and Appendix A be sealed and brought into effect
 - To agree to advertise an amended proposal

- To withdraw the proposal

Background Papers

Parking Services Files

Consultation Statement

The Portfolio Holder for Transport, Licensing and Community has been consulted on the proposal outlined in this report.

Attachments

Appendix A Proposed Parking Restriction

Appendix B Summary of Key Points from Responders

ROGER WALTON

Strategic Director (Operations & Commercial)

The officer to whom reference should be made concerning inspection of the background papers is the Parking Operations Manager, Dover District Council, White Cliffs Business Park, Dover, Kent CT16 3PJ. Telephone: (01304) 821199, Extension 42422

This map is reproduced from Ordnance Survey material with the permission of Ordnance Survey on behalf of the Controller of Her Majesty's Stationery Office © Crown copyright. Unauthorised reproduction infringes Crown copyright and may lead to prosecution or civil proceedings. Dover District Council licence no. 100019780 published 2021.

Appendix A

This map is reproduced from Ordnance Survey material with the permission of Ordnance Survey on behalf of the Controller of Her Majesty's Stationery Office © Crown copyright. Unauthorised reproduction infringes Crown copyright and may lead to prosecution or civil proceedings. Dover District Council licence no. 100019780 published 2021.

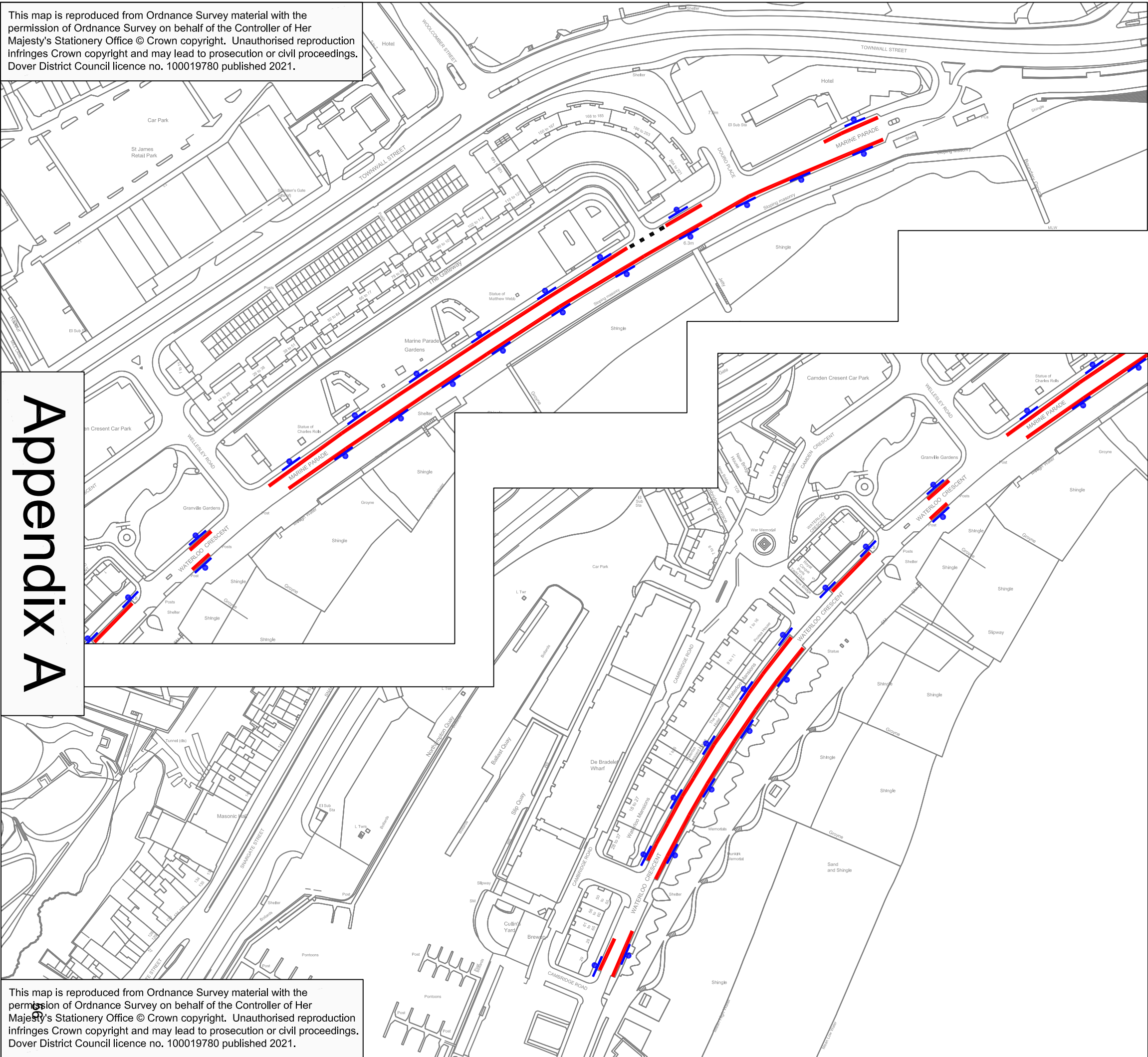

Key to Map

 Extent of Proposed Pay & Display (P&D) parking as detailed on sign below

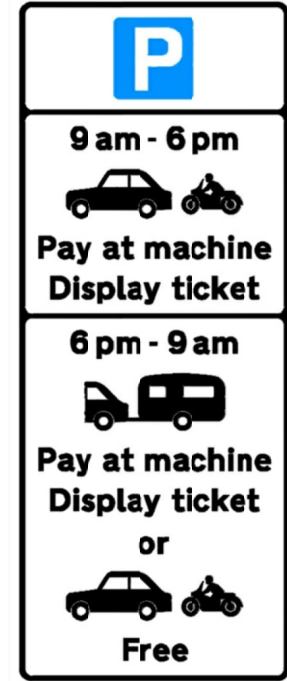

 Signs on posts at 30 metre spacing (nominal)

 New double yellow lines to protect driveway to The Gateway



Prepared by
 Parking Services
 Dover District Council
 Honeywood Close
 White Cliffs Business Park
 Dover CT16 3PJ
 Tel: (01304) 821199

Euring Roger Walton, C.Eng, M.I.C.E.
 STRATEGIC DIRECTOR (OPERATIONS & COMMERCIAL)

Scheme
**Proposed Daytime P&D Parking with
 Overnight P&D Caravan and Motor Caravan
 Parking**

Location
**Marine Parade and Waterloo Cres,
 Dover Seafront**

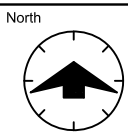

Designed: GEM Drawn: GEM Date: 19 Jan 2021

Scale  1 in 2000 (A3 size) Drawing Number **TRAN/2020/0005** Rev **C**

Summary of Key Points Raised by Responders

(Proposed Overnight Motor Caravan Parking Prohibition, Dover Seafront)

Response to proposals: Objections 13, Support 3

Key points raised by Objectors:

- By far the majority of these are foreign registered vehicles on a “comfort” stop before onward travel or awaiting embarkation. The proposed changes will, undoubtedly, adversely affect many of these travellers. The £10 overnight charge for motorhomes and caravans will deter “overnight” parking of both GB and foreign registered vehicles. Foreign drivers are likely to ignore the proposed charges with all that ensues for monitoring and enforcement. Health and safety require a period of rest from driving that may well be ignored if onward travel is continued when a break is deemed unnecessary. Current free parking overnight allows this safety to be achieved. Where would these visitors go to find alternative parking? Enforcement of parking fines requires permanent overnight patrols requiring extra manpower and attendant cost implications (ultimately a charge passed to DDC taxpayers). Visitors to Dover (even those transiting the area) deserve to be welcomed to our town and not driven away by an extortionate levy on their short stay. For the above reasons, I object to the proposed changes to parking on Dover Seafront.
- As a tenant of Waterloo Mansions, we have witnessed over the past couple of years since we have been there, the seafront being used and sometimes abused by owners of caravans and motorhomes. We have witnessed the area being used as a public toilet which includes the front gardens of Waterloo Mansions. In December 2020 when the Port was gridlocked for 4 days prior to Christmas, HGV and van drivers were using the area as a toilet because there are no facilities down there. There is also the issue of rubbish. The bins that are there are inadequate, allowing seagulls to gain access them and disperse the rubbish everywhere. Again, the bins that are there are not emptied enough. Most of the residents and tenants are now retired, looking for a peaceful life; this I feel will destroy the peace and quiet of the seafront. It always seems as though when these ideas are put in place, those that live in the areas of concern are never consulted. I know you have invited us to send our concerns but how do we know anybody takes any notice of them or even takes them seriously? Sad to say at the end of the day it all comes down to revenue for the Council and I fear that will be the reason this will probably go ahead.
- I strongly object to the instigation of parking fees for overnight parking of caravans and motorhomes on Marine Parade and Waterloo Crescent. There is no valid reason, apart from extracting money from visitors to Dover, for the imposition of overnight parking fees, when the same does not apply to cars and goods vehicles under 3500kg as most caravans and motorhomes are under 3500kg.
- We totally oppose the proposal for the following reasons. We did not buy a £1/4m apartment to look at, basically what will be, a caravan park. There are no controls as in management whereby the area will be monitored at **all** times, so that people are not parking outside the timings. We have seen over the years many caravans, motorhomes etc., parked along Marine Parade at times when they should not park, and nobody seems to mind. There are no facilities as in toilets for these people to use. No facilities for washing etc. I appreciate you will respond by saying they have the facilities in their vehicles, but the managing, as in emptying etc., which you can do on a caravan park, but not on a seafront. Totally unhygienic. No facilities for disposal of rubbish, other than the bins along the seafront. No control over noise at night. No control over delinquent behaviour. Dogs seem to be unsupervised along Dover seafront. This will be exacerbated with this caravan park and their pets. It is very sad to see the way dogs foul the seafront, the new pier etc., day after day without repercussions. It is also a health hazard, especially on the beach. You have empty waste land where the Dover Swimming baths used to be. Would you not consider using that area for this purpose? You could put toilet and washing facilities which could be monitored by a security guard. They would be contained in one area without being spread along the whole seafront, turning the environment of the seafront into a caravan park. Very sad.

- I wish to OBJECT to the proposed parking charge on Dover Seafront areas as when used it may only be for a 2hr period between the hours of 1800 & 1600, so the proposed £10 charge is excessive for such a short period. I am sorry but this action will deter people from travelling out of Dover Port and, in the long term, lead to lost revenue for the Borough.
- I would like to strongly object to your proposal, as would the rest of my team.
- I write to formally object to the proposed parking charges for motorhomes and caravans on Dover seafront between the hours of 6pm and 6am. My reasons are, the parking is not oversubscribed, no charge is justifiable. The parking is typically used as a rest stop for those transiting the Channel. It will disproportionately affect UK drivers as foreign vehicles are likely to ignore any charge or subsequent fine. It strikes me as a simple money-making exercise at the disproportion detriment to the travelling motorist. It also targets unfairly the leisure traveller by specifying caravans or motorhomes. This by implication would then not apply to other types of vehicles that people may sleep in, e.g., curtain sided transport vans with sleeping cabs etc.
- I remember a questionnaire last year, I disagreed with it then as I disagree now. You have not supplied one public toilet or one ablution block along the seafront! The drivers of these vehicles leave all sorts of rubbish along the seafront, including human excrement, in plastic bags! Last summer we even had ethnic community representatives occupying pavements with their chairs, tables and whatever. They cooked on the pavement too and again left bags of leftover food on the lawn, inviting rats, seagulls and foxes. Is this hygienic? Do you care?? Is DDC interested in what the people say? No. All that interests you is taking parking fees and Council tax. I am disgusted with the present Council. I sincerely hope to vote you out in the next local election!
- I strongly object to any motorhome or caravan parking on the seafront. The owners/users empty their toilets and rubbish bins in the Gateway gardens. The noise of them going and coming is awful, they do not seem to realise it is a residential area and conduct their meeting and greetings at the top of volume all night long. With their noise and dumping of their stinking waste, life becomes intolerable during the summer months. No caravans or motor caravans at all on Dover seafront please.
- I live in the Gateway Flats and *centre stage* to the seafront (Marine Parade) and the proposed changes to parking restrictions set out in your letter dated 6th February 2021 with attendant drawing (TRAN/2020/0005 - Rev C).

You ask for comment/objection to the proposal. My views derive from personal experience over the past five years and I would not wish to speak for others.

Present parking arrangements in this area allow overnight parking free of charge (6pm-9am). Covid restrictions aside, overnight parking comprise chiefly motor homes and the occasional caravan that have alighted from, or waiting to embark, ferries at Dover Eastern Docks.

By far the majority of these are foreign registered vehicles on a ‘comfort’ stop before onward travel or awaiting embarkation.

Although summer is the busiest time, this is an all-year round phenomena.

Most arrive early afternoon or evening and depart before the present 9am parking charges come into force. Others arrive during the late evening or night following disembarkation seeking a rest before continuing their journey. Cars (without caravans) parked overnight are unusual and small in number. Save one exceptional circumstance where two associated GB registered mobile homes stayed for 48 hours, were somewhat vocal and departed leaving litter behind, no others, in my experience, have caused any problem or nuisance during their stay, despite being situated within 60-70 metres of Gateway flat residents. Some regard these overnight stayers as a nuisance and an eyesore. I dissent from those views. Better to look out on a quiet social scene than an empty road.

The proposed changes will undoubtedly adversely affect many of these travellers.

The £10 overnight charge (in truth not actually just overnight but applicable from 6pm every day of the week) for motor homes and caravans will deter 'overnight' parking of both GB and foreign registered vehicles. Whilst GB registered vehicle drivers will think twice about paying £10 just for the privilege of simply sleeping in their vehicle for a short period overnight, they are likely to disperse elsewhere in the locality with potential adverse consequences for the town [see footnote].

Foreign drivers are likely to ignore the proposed charges with all that ensues for monitoring and enforcement. [*Presently supermarket delivery vehicles often park on the seafront whilst making deliveries up to 10pm at night. Is it proposed that they too should pay £10 for each and every visit to many local shoppers who are unable to shop in person?*]

Health and Safety requires a period of rest from driving that may well be ignored if onward travel is continued when a break is deemed necessary (not, as for larger vehicles a legal requirement but nonetheless as important to keep our busy roads safe). Current free parking overnight allows this safely to be achieved.

Where would these visitors go to find alternative parking? In-town off street parking is available and currently free of charge overnight although Stembrook car park is just as much in a residential area as the seafront and with capacity limitations. Albany Place car park is another possibility as is the old Dover Leisure Centre car park but again with limited capacity.

Enforcement of parking fines requires permanent overnight patrols requiring extra manpower and attendant cost implications (ultimately a charge passed to DDC taxpayers).

Fines levied on foreigners are all but unenforceable (even more so now that we have left the EU) and where attempted will incur recovery costs far in excess of the £10 charge or the manpower needed to monitor and enforce recovery.

Visitors to Dover (even those transiting the area) deserve to be welcomed to our town not driven away by an extortionate levy on their short stay. In my view this proposal is nothing more than an ill-conceived attempt to raise cash at the expense of our visitors and doomed, I suspect, to fail as an economically unsound proposal and a waste of taxpayer money.

For the above reasons I object to the proposed changes to parking on Dover Seafront.

Note: Proposed Parking (P&D) signage. This sign as per your 'Key to Map' is totally incomprehensible to most foreign visitors in a camper van/mobile home. They are neither a caravan nor a car as depicted. Although this is made clearer on the Machine Tariff Label the roadside signage is unhelpful and what visitors first see.

- I would like to see Motor homes and Caravans Banned at anytime for reasons.
 - [1] They come and go at all times of the night some toot their horns.
 - [2] They leave a substantial amount of rubbish cleared at ratepayers expense.
 - [3] Some use our bushes and underpass as a toilet which the Residents have to pay to be cleaned and Disinfected .

If the Proposal goes ahead it should be enforced on a regular basis. Payment should include Blue Badge holders. How will Fines be collected if people live outside of the UK or of no fixed abode.

- We wish to raise objections to the above proposal on the grounds of anti social behaviour. Whilst some of the owners are respectful of their surrounding there are a large element that are not. It is not acceptable to expect the residents that live near by or the people of Dover to accept people urinating and defecating in the sunken gardens or the beach. Nor pouring urine down the drains. We have seen both. We would question what facilities you intend to provide for the travellers? The bins provided may look in keeping with the surroundings but they are not fit for purpose, they are not large enough to take the waste left by people staying over night.
- This is a total disaster and, if permitted, would surely represent the final nail in the coffin for our once proud town. The seafront, recently upgraded by Dover Harbour Board, is just about all we have left of the historic Gateway to England, free of through traffic. The seafront is lined with residential properties, hotels, restaurants and the Yacht Club, all very popular venues from which to enjoy the unique view. All this would be lost, and businesses would suffer badly. To permit caravans and

trailers to park in the evenings and overnight is totally misguided and wrong, particularly as a practical, viable option is planned on the A20 outside town. The disruption from people, children, dogs and rubbish would be unbearable. No more quiet evening strolls along the seafront, no more peaceful evenings overlooking the famous view, just rows of noisy, smelly wagons. Quite frankly, it is difficult to believe that anyone with the slightest knowledge of, or regard for our town and its inhabitants could seriously contemplate such a proposal.

Key points raised by Supporters:

- I am writing to agree with the proposal, but with a few important considerations; These proposals must be strictly adhered to with regular checks throughout the night. Additional larger bins for all the rubbish which ends up along the grass areas in front of the Gateway Flats. Please, please install bins that are fox and seagull secure. Please ensure that lorries and coaches do not use these proposed parking areas for their use. Daily litter picking from 7am to stop it being blown along the seafront. The Caravan Club advertises free parking along the Seafront overnight, they and similar organisations need to be notified in advance.
- I raised this matter about 5 years ago and am glad to see that someone, at last, has decided to “bite the bullet” and shown some positive action in this matter. I hope that it will contribute to the Budget for the Council and possibly reduce our Council Taxes! People using the spaces, as a free convenience will now have to contribute to the local economy when using local resources. Hopefully, it will also reduce the amount of rubbish they leave behind for the Council to clear. My only suggestion is that the signs should include a logo representing a motor caravan. The sign shown in your letter, could lead to a confusion with a MC owner believing that because a MC logo is not shown, it does not apply to him and it is free. This leads to fines, time wasted and expensive legal costs for the Council having to follow up those prosecuted. I seem to remember some years ago, the French having on their signs a logo for both caravans and MCs to ensure that there were no disputes or misunderstanding.
- I have no objections to caravans or motor caravans parking on Dover sea front, in fact I think they bring some trade to local restaurants and shops in the area.

Other comments submitted:

- I still cannot believe that your previous correspondence on using the beautiful Dover seafront as an approved caravan park got a positive response. Who voted for it? However, I understand it was and we are now asked about the £10 charge. I assume it is much lower than any real caravan site, which provide proper facilities, like toilets. Therefore, it will not discourage any van owners, desirable or not, from using it. Is there any reason why it could not be higher? Is it legally possible to apply conditions to those parking and indicate these on the ticket? Most people parking are reasonable, but a small minority are not and do not respect how near they are to a residential area. Could they, for example: 1) Be asked not to play loud music or generally be noisy; 2) Be asked to be inside their vans by 22:30; 3) Be asked not to use the garden as a toilet (or allow their dogs to); 4) Keep their rubbish inside their vans if the public bins are full. Finally, could the arrangement be subject to review after 12 months in the light of experience? Those parking could be notified of this too.
- I have seen the proposal to charge £10 for parking of motorhomes and caravans overnight for Marine Parade and Waterloo Cres. Whilst I understand that some may see it is a nuisance having such vehicles parking overnight – a lot or coming to Dover to catch the ferries, or having just come off a ferry, it is not sensible to force drivers to continue driving when tired. The Port does not provide any area for MHs to park up to wait for ferries. Also, quite a lot of MH owners would be using local amenities for food, shopping before catching ferries – a £10 charge is astronomical for a parking place. Over the water in France, £10 provides a secure overnight stop with water, waste and electricity. I feel a charge of £5 is very reasonable and would not push MH owners to park in other areas of town. If not, please push for ferry companies to provide a suitable waiting place.
- I do not object to the proposal outlined in your letter per se. My concern is what is likely to be left behind by those taking advantage of the parking facility and the need for it to be cleared up. 60

- I am pleased, after many months of waiting, that a decision has been made with regards to Over Night Parking on the Seafront. Over the 10 years of living in the Gateway Flats, we are aware that many Caravans and Motor Homes arrive and park after 22.00 hours and leave well before 07.00hours. How is it proposed to ensure that those that arrive late and leave early are issued with a Parking Ticket? Are you going to have Parking Ticket Officers patrolling all through the night? I also ask whether is is proposed to provide toilet and washing facilities on the seafront? Over recent years the adjacent sunken gardens are bushes are frequently used.

DOVER DISTRICT COUNCIL

DOVER JOINT TRANSPORTATION ADVISORY BOARD – 18 MARCH 2021

EXCLUSION OF THE PRESS AND PUBLIC

Recommendation

That, under Section 100(A)(4) of the Local Government Act 1972, the public be excluded from the meeting for the remainder of the business on the grounds that the item to be considered involves the likely disclosure of exempt information as defined in the paragraph of Part I of Schedule 12A of the Act set out below:

<u>Item Report</u>	<u>Paragraph Exempt</u>	<u>Reason</u>
Applications for Disabled Persons' Parking Bays	1 and 2	Information relating to any individual and Information which is likely to reveal the identity of an individual

DOVER JOINT TRANSPORTATION BOARD

PROCEDURE FOR DETERMINING APPLICATIONS FOR ON-STREET DISABLED PERSONS' PARKING BAYS

1. Under the current arrangements with Kent County Council (the Highway Authority), an applicant has to satisfy a list of criteria set by the County Council in order to qualify for a disabled person's parking bay being provided outside, or close to, his or her house. The set of criteria was adopted by this Board at its meeting held on 7 February 2005 and is as follows:
 - All applicants must hold a current and valid Blue Badge
 - All applicants must also be in receipt of, or have proof of entitlement to:

Personal Independence Payment (PIP) at the enhanced rate **or**

If under 65 years of age - entitlement to the higher rate mobility component of the Disability Living Allowance **or**

If 65 years or over – entitlement to the Higher Rate of Attendance Allowance if applicant was 65 years or over when entitlement was first claimed **or**

Another entitlement which may be allowable e.g. War Pension.
 - The applicant must not have any space available for parking their vehicle in an off-street parking facility.
 - There are parking problems within the road, for example, the applicant regularly has difficulty finding available space on-street close to his or her property (this will be assessed post-application by a highway engineer).
2. Bays will not be provided in locations which may compromise public safety, e.g. on a bend or brow of a hill, close to a junction, within a turning head of a cul-de-sac, where the road is too narrow or where parking is already prohibited, e.g. on yellow lines, zigzag lines, etc.
 3. The provision of a disabled persons parking bay **must** relieve congestion on the public highway.

Process after receipt of application

4. Providing the applicant meets the criteria set out above, the first stage in processing the application is that neighbours who may be immediately affected by the provision of a bay will be informally consulted.
5. Once informal consultation has been completed, the proposals (including any objections received) will be reported to the Dover Joint Transportation Board which will make an initial decision on whether the application should be refused or progressed to the second stage of formal advertisement and consultation. A

recommendation to refuse the application would be made to Kent County Council and would mean that the application proceeds no further.

6. If the Board agrees that the application should be progressed to the second stage, a Traffic Regulation Order (TRO) will be made. This is a legal document that allows the Highway Authority to regulate the use of bays and helps to prevent their misuse. The proposed TRO will be advertised in a local newspaper and affected parties will be formally consulted.
7. At this stage, a bay may be marked on the highway. However, it will not be enforceable until the TRO has been formally made (or 'sealed').
8. If objections are received during the formal consultation stage, they will be reported to the Dover Joint Transportation Board for a further decision. In the event that Kent County Council accepts a recommendation from the Dover Joint Transportation Board to refuse an application, the interim bay will be removed. If the Board makes a recommendation to approve the application, the TRO will be sealed. (If no objections are received during the formal consultation stage, the TRO will be sealed without further reference to the Board.)
9. It should be noted that the applicant will not have exclusive rights to the parking bay. Anyone holding a valid Blue Badge may park in the bay.
10. A TRO can take between 9 and 12 months on average from when it has been agreed in principle to the time of implementation. It is a lengthy process due to the need for the Council to adhere to the statutory procedures laid down by the Department for Transport.
11. When a bay is established on the highway it will be assessed periodically against the criteria to ensure that it is still justified. If the bay is no longer required for the original use or the criteria are no longer met, it may be removed.

By virtue of paragraph(s) 1, 2 of Part 1 of Schedule 12A
of the Local Government Act 1972.

Document is Restricted

By virtue of paragraph(s) 1, 2 of Part 1 of Schedule 12A
of the Local Government Act 1972.

Document is Restricted

By virtue of paragraph(s) 1, 2 of Part 1 of Schedule 12A
of the Local Government Act 1972.

Document is Restricted

By virtue of paragraph(s) 1, 2 of Part 1 of Schedule 12A
of the Local Government Act 1972.

Document is Restricted

By virtue of paragraph(s) 1, 2 of Part 1 of Schedule 12A
of the Local Government Act 1972.

Document is Restricted

By virtue of paragraph(s) 1, 2 of Part 1 of Schedule 12A
of the Local Government Act 1972.

Document is Restricted

By virtue of paragraph(s) 1, 2 of Part 1 of Schedule 12A
of the Local Government Act 1972.

Document is Restricted

By virtue of paragraph(s) 1, 2 of Part 1 of Schedule 12A
of the Local Government Act 1972.

Document is Restricted

By virtue of paragraph(s) 1, 2 of Part 1 of Schedule 12A
of the Local Government Act 1972.

Document is Restricted

By virtue of paragraph(s) 1, 2 of Part 1 of Schedule 12A
of the Local Government Act 1972.

Document is Restricted

By virtue of paragraph(s) 1, 2 of Part 1 of Schedule 12A
of the Local Government Act 1972.

Document is Restricted

By virtue of paragraph(s) 1, 2 of Part 1 of Schedule 12A
of the Local Government Act 1972.

Document is Restricted

By virtue of paragraph(s) 1, 2 of Part 1 of Schedule 12A
of the Local Government Act 1972.

Document is Restricted

By virtue of paragraph(s) 1, 2 of Part 1 of Schedule 12A
of the Local Government Act 1972.

Document is Restricted

By virtue of paragraph(s) 1, 2 of Part 1 of Schedule 12A
of the Local Government Act 1972.

Document is Restricted